

INSTRUCTION MANUAL

Minnie Mouse 6 volt Car

Item No.: 8453
Model No.: D8010

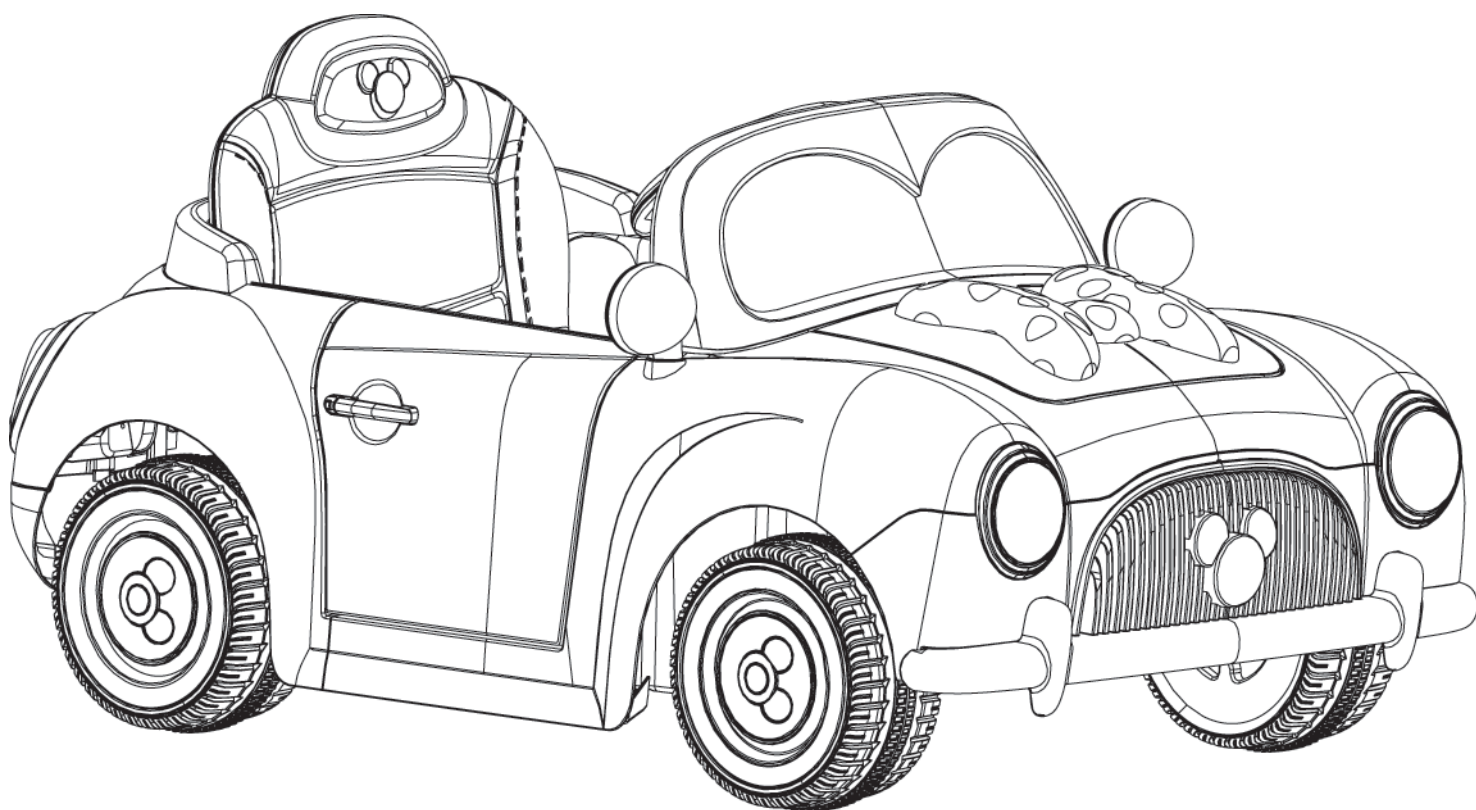

Styles and colours may vary.



Hunter
Products

For after sales service, replacement parts or
general enquiries please contact:

Web: www.electricrideon.com.au

Toll Free Service Phone: 1800 224 094

Email: enquiries@hunterproducts.com.au

SUITABLE FOR AGES 3 YEARS +
MAXIMUM USER WEIGHT 30KG
ONLY 1 RIDER AT A TIME

Contents

Before First Use:	2.
Product Specifications:	3.
Safety Precautions & Warnings:	4-7.
Parts Description:	8.
Assembly Instructions:	9-10.
Direction of use:	11.
Charging Instructions:	12 .
Reset Fuse:	13.
Maintenance:	14.
General Care:	15.
Troubleshooting:	16- 17.
Customer Service Information:	18.
Warranty:	19.

Before First Use: 2

This **Instruction Manual** contains important safety information as well as assembly, use and maintenance instructions. This car must be assembled by an adult who has read and understands the instructions in this manual. Keep the packaging away from children and dispose of properly before use.

Keep this manual for future reference.

3 Product Specifications:

EXTERNAL DIMENSIONS	1070 x 651 x 525 mm	POWER MODE	Rechargeable
AGES	3+ years	FUSE SPEC	7 amp Thermal Fuse
MAX WEIGHT LIMIT	30 kg	CHARGING TIME	8-12 hours(charge) 1-2 hours (use)
SPEED	3 km/hr	CHARGING SPEC	AC100-240V, 50Hz(input) DC8V 800mA(output)
BATTERY SPEC.	6V 7AH SLA		

For after sales service, replacement parts or general enquiries please contact:

Web: www.electricrideon.com.au

Toll Free Service Phone: 1800 224 094

Email: enquiries@hunterproducts.com.au

Safety Precautions & Warnings 4



WARNING!

The following safety hazards may result in serious injury or death to the user of the vehicle Minnie Mouse 6v Car Ride-on:

- This product contains small parts that are for adult assembly only. Keep small children away when assembling. Remove and dispose of all protective material and poly bags before assembly. Be sure to remove all packaging materials and parts from underneath the car body.
- Riding the vehicle without a helmet. Riders must always wear a fitted helmet that complies with Australian Standard AS/NZS 2063:2008.
- Battery posts, terminals and related accessories contain lead and lead compounds (acid) chemicals that are toxic and corrosive. Never open the battery.
- Body parts such as hands, legs, hair and clothing can get caught in moving parts. Never place a body part near a moving part or wear loose clothing while using the vehicle. Always wear shoes when using the vehicle.
- Using the vehicle near streets, motor vehicles, drop-offs such as: steps, water (swimming pools) or other bodies of water, sloped surfaces, hills, wet areas, flammable vapors, in alleys, at night or in the dark could result in an unexpected accident.
- Always use the vehicle in a safe, secure environment with continuous adult supervision. Never leave the child unattended.
- Using the vehicle in unsafe conditions such as snow, rain, loose dirt, mud, sand or fine gravel may result in unexpected action such as tip over and skidding.
- Using the vehicle in an unsafe manner. Examples include but are not limited to:
 - Pulling the vehicle with another vehicle or similar device
 - Allowing more than one rider
 - Pushing the user from the back
 - Traveling at an unsafe speed
- Always use common sense and safe practices when using the vehicle. Different type of batteries or new and old batteries are not to be mixed.
- Not to be used in traffic
- This toy is unsuitable for children under 3 years due to its maximum speed.
- Battery charger, electric wire plug enclosure and other parts should be periodically check for damage, if have damage, need to repair before use.
- There are additional hazards of using the toy in areas other than private grounds.

5 Safety Precautions & Warnings (cont.)

Age Range	3 to 7 years
Weight Range	No more than 30kg

Before using the vehicle the child should understand the vehicle controls and safety issues. They must also demonstrate the capability to handle the vehicle and operate its controls. It is the responsibility of the adult to educate the child and supervise use of the vehicle.

Read the following safety warnings to any child using the vehicle:



WARNING!

PREVENT INJURIES AND DEATHS:

- **NEVER LEAVE CHILD UNATTENDED. ALWAYS** keep child in view when child is in vehicle. Direct adult supervision is **REQUIRED**.
- **NEVER** use in roadways, near cars, on or near steep inclines or steps, swimming pools or other bodies of water.
- **ALWAYS** wear shoes.
- **ALWAYS** sit on the seat.
- **RISK OF FIRE.** Do not bypass.
- **NEVER** allow more than one (1) rider in the vehicle.
- Adult assembly required.
- Only use the vehicle when an adult is present to watch (supervise).
- Always sit in the seat when using the vehicle.
- Keep your hands, hair and clothes away from moving parts.
- Always wear shoes when using the vehicle.
- Only one rider is allowed at a time on the vehicle.
- Children under three years old cannot use the vehicle.
- Only drive on level ground.
- Do not go near water, drop-offs or up and down steep slopes.
- Do not drive the vehicle into loose dirt, mud, and or fine gravel.
- Do not drive the vehicle on streets or near cars.



WARNING!

The following safety hazards may result in serious injury or death to the user of the vehicle:



- Use of a battery or charger other than the supplied 6v rechargeable battery and charger may cause a fire or explosion. Only use the supplied 6v rechargeable battery and charger with the vehicle.
- Using the 6v rechargeable battery and charger for any other product may result in over heating, fire or explosion. Never use the 6v rechargeable battery and charger with another product.
- Explosive gases are created during charging. Charge the battery in a well ventilated area. Do not charge the battery near heat or flammable materials.
- Contact between the positive and negative terminals may result in fire or explosion. vehicle direct contact between the terminals. Picking up the battery by the wires or charger can cause damage to the battery and may result in a fire. Always pick up the battery by its case or handles.
- Liquids on the battery may cause fire or electric shock. Always keep all liquids away from the battery and keep the battery dry.



- Contact or exposure to battery leakage (lead acid) may cause serious injury. If contact or exposure occurs immediately call your physician. If the chemical is on the skin or in the eyes, flush with cool water for 15 minutes. If the chemical was swallowed, immediately give the person water or milk. Do not give water or milk if the patient is vomiting or has a decreased level of alertness. Do not induce vomiting.

7 Safety Precautions & Warnings (cont.)



WARNING!

- Battery posts, terminals and related accessories contain lead and lead compounds (acid), chemicals and are toxic and corrosive. Never open the battery.



- Tampering or modifying the electric circuit system may cause a shock, fire or explosion and permanently damage the system. Exposed wiring, circuitry in the charger may cause electric shock. Always keep the charger housing closed.

Important! Before using the vehicle for the first time the battery needs to be charged for a full 16 hours. Only an adult who has read and understands the following safety warnings should handle, charge or recharge of the battery (see Maintenance).



WARNING!

- Non-rechargeable batteries are not to be recharged;
- Batteries are to be inserted with the correct polarity;
- Exhausted batteries are to be removed from the toy;
- The supply terminals are not to be short-circuited.
- Rechargeable batteries are only to be charged under adult supervision;

Parts Description 8

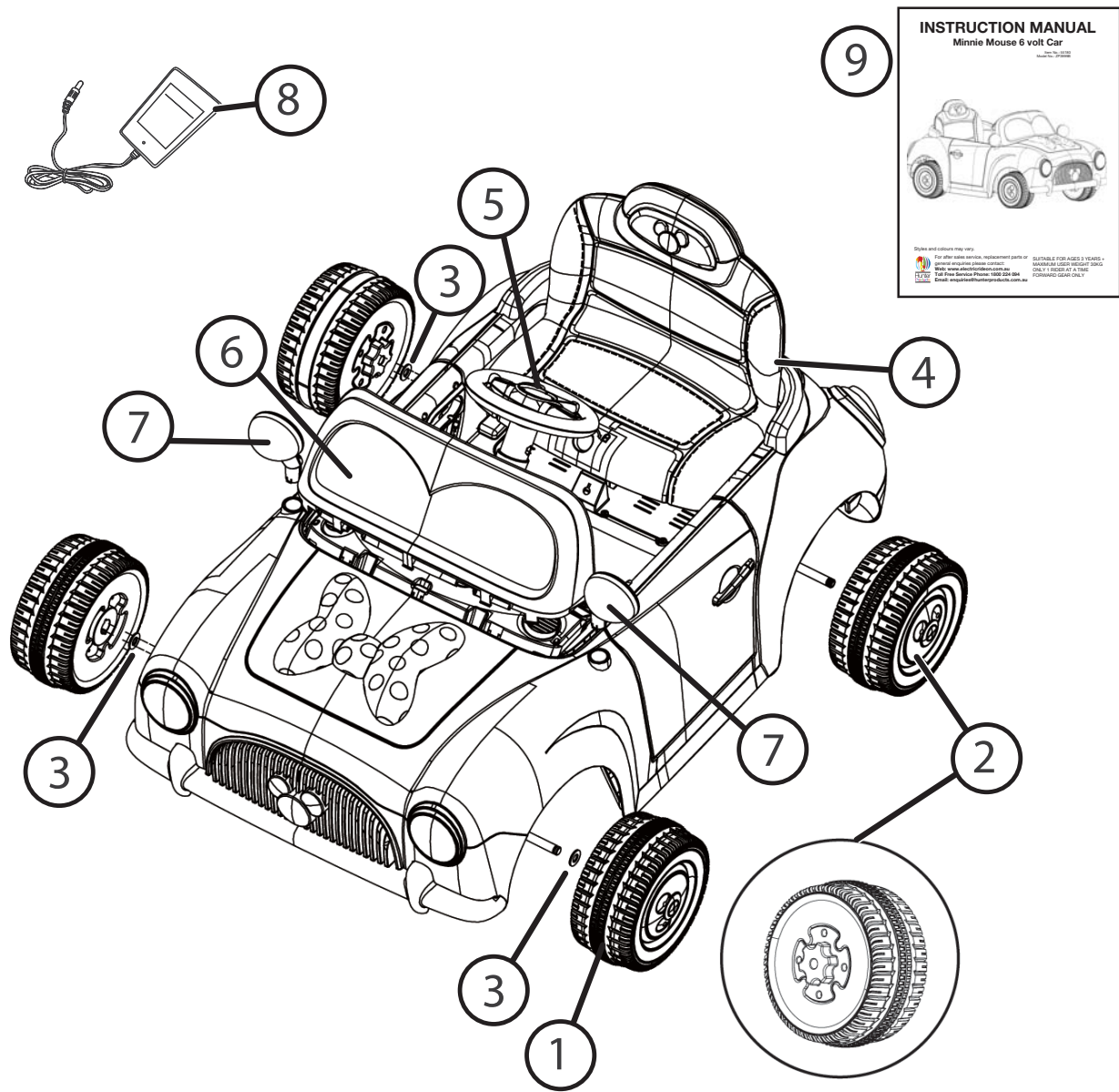

Parts description	Quantity
Front wheel	2
Rear wheel	2
Washer	3
Seat	1

Parts description	Quantity
Steering wheel	1
Windshield	1
Rearview mirror	2
Charger	1

Parts description	Quantity
Instruction Manual	1

9 Assembly Instructions

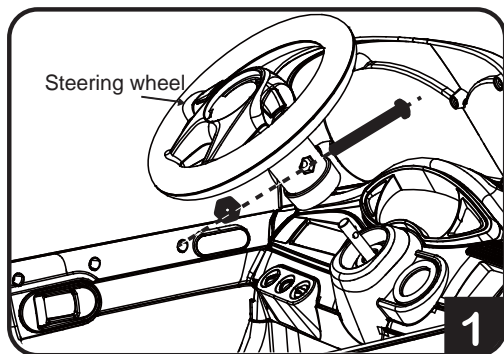

1: Install the steering wheel:

Remove the bolt and nut from the steering wheel and fit over the steering rod.

Place bolt and nut back through steering wheel and rod to fix in place.

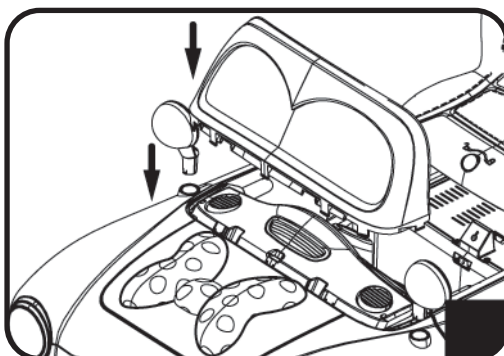

2: Installing the windshield and rear view mirrors.

Clip the wind shield into the recess holes on the dash.

Clip the rear view mirrors into the recess holes.

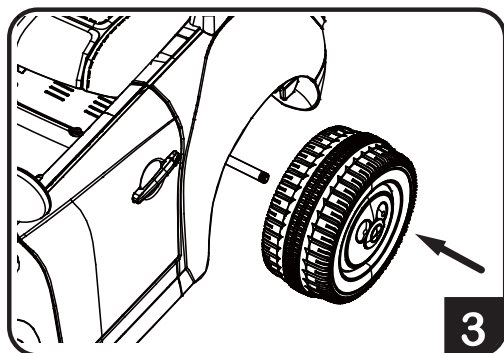

3: Install the rear left wheel:

Slide the rear wheel onto the rear axle ensuring it is aligned with gearbox and click both rear wheels into place.

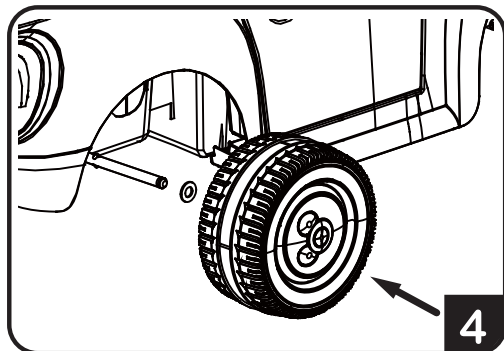

4: Install the rear right wheel:

Make sure flat washer is fitted to rear axle

Slide the rear wheel onto the axle & click into place.

Assembly Instructions 10

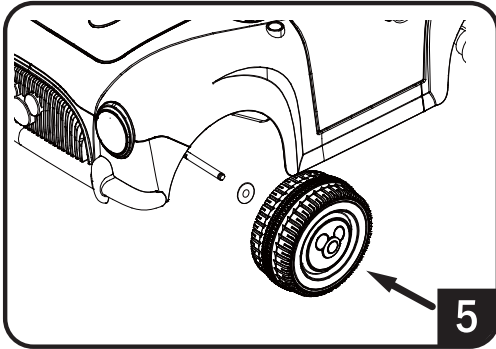

5: Install the front left wheel:

Make sure flat washer is fitted to front axle

Slide the front wheel onto the axle ensuring it is clicked into place.

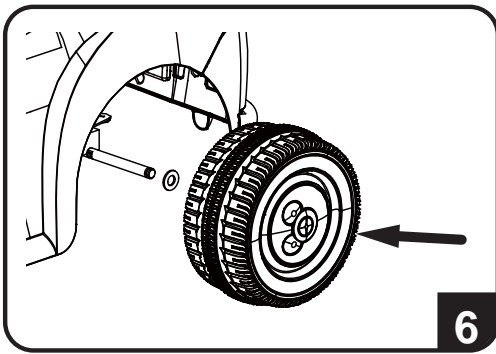

6: Install the front right wheel:

Make sure flat washer is fitted to front axle

Slide the front wheel onto the axle ensuring it is clicked into place.

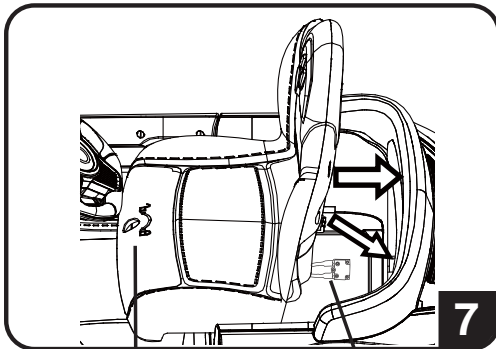

7: Connect the Fuse & Install Seat

Connect the loose cable to the small thermal fuse as per image 7.

Insert the clip of the seat into the recess hole.

Turn the locking knob on the seat to lock into position.

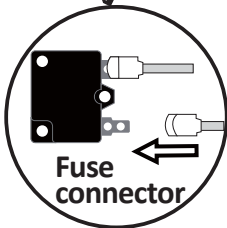
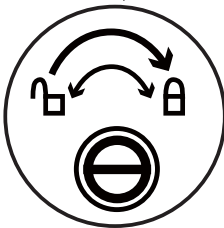

11 Directions of use

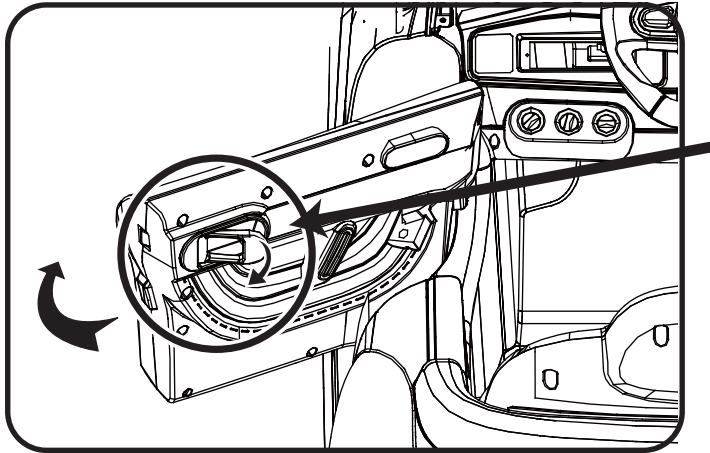

Opening & Closing Doors

Pull the door handle inside the door to open.

Reverse this step to close the door.

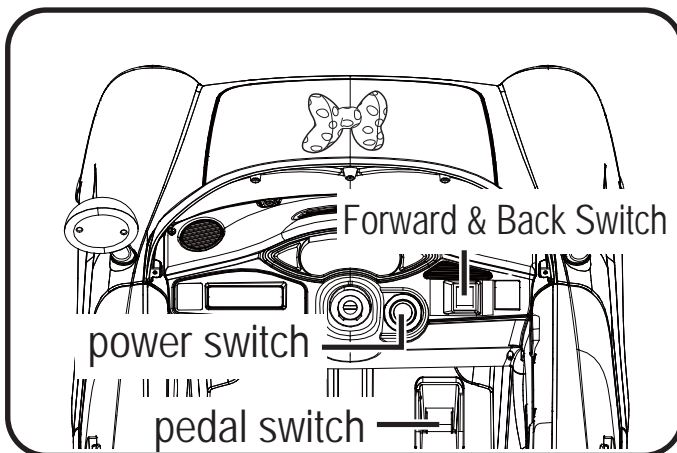

Driving the Vehicle

Turn the car on via the power button.

Select forward or back from the gear switch.

Step on the foot pedal to operate the car.

Release your foot to stop the car.

To Charge the Battery:

- 1: Ensure the car is stopped and turned off.
- 2: Plug the round charge pin into the charge port located below the front of the driver seat.
As per image below.
- 3: Plug transformer into a 240 V outlet.

NOTE: First time charge should be for 16 hours

Subsequent charges should be 8-12 hours.
Do not charge for more than 18 hours.

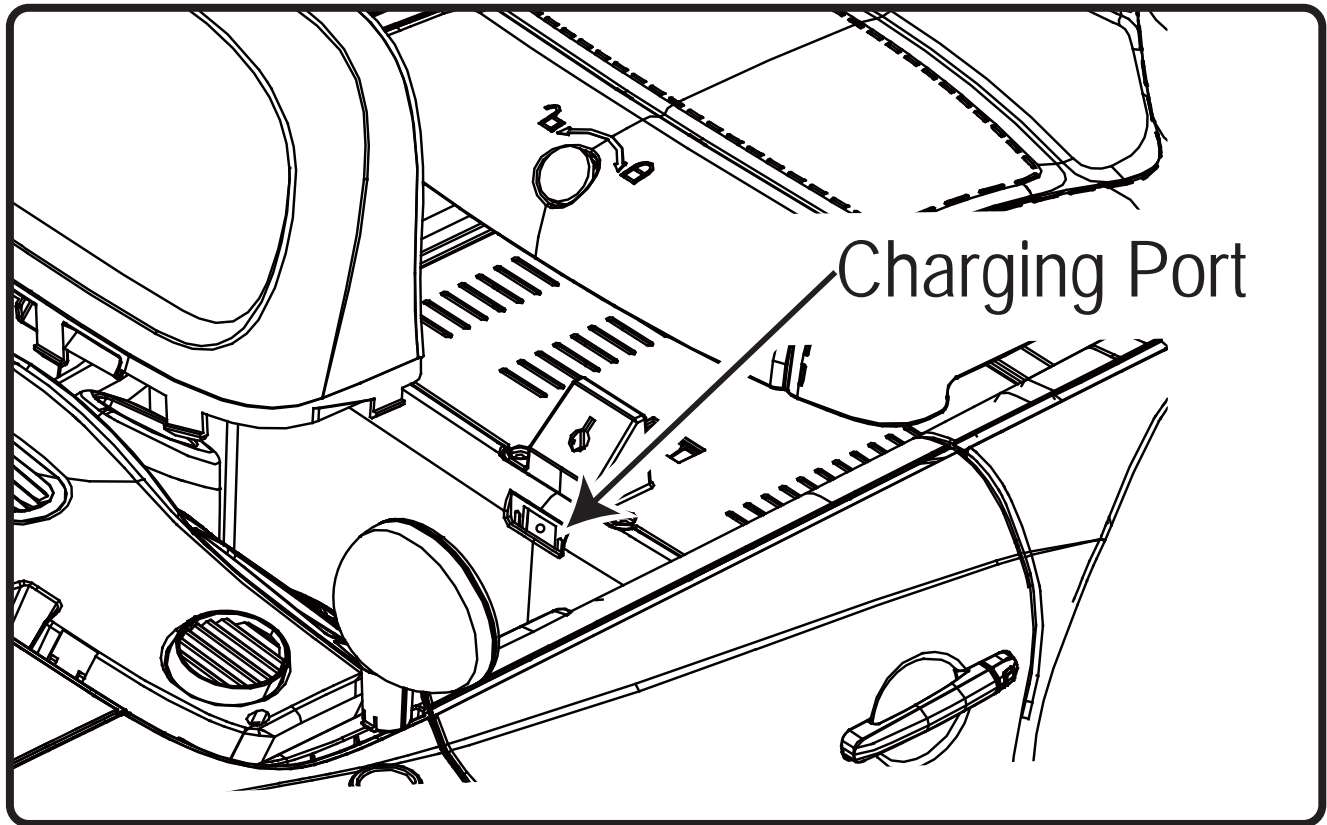

**Please note car will not work while charger is connected.
Disconnect charger from car before attempting to operate.**

13 Reset Fuse

Thermal Overload Fuse:

This car is fitted with a thermal overload fuse. If the car is overloaded the fuse will cut off power to the car for 10-20 seconds before resetting itself.

To avoid the fuse activating please follow the below guidelines.

- 1: Maximum user weight is 30kg
- 2: Do not tow or overload car with weight.
- 3: Do not get the car or its electric components wet.
- 4: Do not alter the cars circuitry or construction.

Important Battery and Charger Information

- Only an adult who has read and understands the safety warnings may handle and operate the battery and battery charger. Keep away from children.
- Charge the battery for 16 hours before using the vehicle for the first time.
- Charge the battery immediately after each use. Charge for at least 8-12 hours, but no more than 18 hours.
- Charge the battery at least once a month, even if the vehicle is not used or stored.
- Never leave the battery in a discharged condition.
- Connect the terminal of the battery and charger, then plug the charger into a 240V AC outlet.
- It is normal for the charger to heat slightly. If the charger rises above 71°C / 160°F, disconnect the charger and call Customer Service for assistance.
- Keep the charger away from water or excessive moisture to prevent short-circuiting.
- Only use the charger specified with the original item. **Do not charge the battery with any other charger.**
- Do not attempt to recharge non-rechargeable batteries with the original charger.
- **Do not replace the battery with any other battery, or the warranty will be voided.**
- Remove damaged batteries from the car immediately. Recycle or dispose of the used batteries responsibly.
- Do not short circuit the supply terminals.
- Do not leave the battery connected in the vehicle for extended periods of time when the vehicle is not being used. Disconnect the battery connector from the engine connector before storing.
- The vehicle is equipped with a thermal fuse to protect the electric circuit. If the vehicle cuts out, turn the vehicle off and on to reset.

15 General Care

- Regularly inspect all vehicle parts to ensure they are in good working condition.
- Regularly inspect the charger, cord, plug, and other related parts for damage.
- Remove any damaged parts and immediately contact Customer Service for replacement parts.
- DO NOT operate the vehicle if there are any damaged parts.
- Carefully clean the vehicle with a damp cloth and mild soap. Do not get water in or near any electrical parts. Do not wash the vehicle with a hose.
- Store the vehicle indoors or use a tarp to cover it. Keep away from stoves, heaters, or other sources of heat.

16 Troubleshooting Guide

Completely read through the manual and troubleshooting guide before contacting Customer Service.

Problem	Potential Cause	Solution
Vehicle does not run	Battery is low	Recharge the battery
	Thermal fuse tripped	Reset fuse
	Snap pins are loose	Tighten snap pins
	Loose wires or loose connectors	Ensure the battery connectors are securely attached. If wires are loose, contact Consumer Service for repairs
	Battery is dead	Call Customer Service for replacement battery
	Electrical system is damaged	Call Customer Service for repairs
	Motor is damaged	Call Customer Service for repairs
Vehicle only runs for a short time	Undercharged battery	Ensure a secure connection when the battery is recharging. Recharge for at least 8-12 hours
	Overcharged battery	Never charge the battery for more than 18 hours
	Battery is old	Replace battery
Vehicle runs slowly	Battery is not fully charged	Ensure a secure connection when the battery is recharging
	Battery is old	Call Customer Service to order replacement battery
	Too much weight on vehicle	Reduce weight on vehicle (30kg max)
	Harsh conditions	Operate the vehicle on level ground and safe surfaces

17 Troubleshooting Guide

Problem	Potential Cause	Solution
Vehicle needs a push to start	Loose wires or loose connectors	Ensure the battery connectors are securely attached. If wires are loose, contact Consumer Service for repairs
	“Dead spot” on motor	A “dead spot” means electricity is not being delivered to the terminal. Contact Consumer Service for repairs
Difficulty shifting	Attempting to shift while vehicle is moving	Stop the vehicle before shifting
Motor or gear box making grinding noises	Motor or gear damage	Contact Consumer Service for repairs
Battery will not recharge	Charger is not plugged in	Plug in the charger to a functional wall outlet
	Charger is not working	Call Consumer Service for a replacement
	Loose connector or loose adapter	Check that the connectors are securely plugged in to each other
Battery makes bubbling noise while recharging	This is normal	No action required
Charger is warm	This is normal	No action required

If your product requires service, repairs or replacement parts, please visit us online at www.electricrideon.com.au

Or contact us at:

Toll Free Service Phone: 1800 224 094

email: www.enquiries@hunterproducts.com.au

Hours: 9.00 AM - 5.00 PM (AEST), Monday - Friday

19 Warranty

One-Year Limited Warranty

Hunter Products warrants that your **Minnie Mouse 6v Car** will be free from defects in materials and workmanship for the vehicle (except for the 6-volt battery) for a period of 12 months, from the date of purchase. This warranty only applies where the product is completely and correctly assembled and used in accordance with all accompanying recommendations and users instructions. This warranty is in addition to your rights under the Australia Consumer Law.

Hunter Products , at its option will provide you with a refund or replacement parts for this product if the **Minnie Mouse 6v Car** becomes defective within the warranty period. Hunter Products will bear the reasonable expense of claiming the warranty. This warranty will no longer apply where the defect is a result of an accident, misuse, abuse, neglect or other causes not arising out of defects in materials or workmanship, nor does it cover damages arising out of damages arising out of service by other than an authorised service person.

Our goods come with guarantees that cannot be excluded under the Australian Consumer Law. You are entitled to a replacement or refund for a major failure and compensation for any other reasonably foreseeable loss or damage. You are also entitled to have the goods repaired or replaced if the goods fail to be of acceptable quality and the failure does not amount to a major failure.

Please retain your receipt as proof of purchase and contact Hunter Products for further assistance on how to process any warranty claims.

Business name:	Hunter Products Pty Ltd
Business address:	Level 2, 424 Warrigal Road, Moorabbin VIC 3189, Australia
Toll Free Phone:	1800 224 094 (Monday to Friday 9.00 to 5.00pm AEST)
Email address:	enquiries@hunterproducts.com.au