

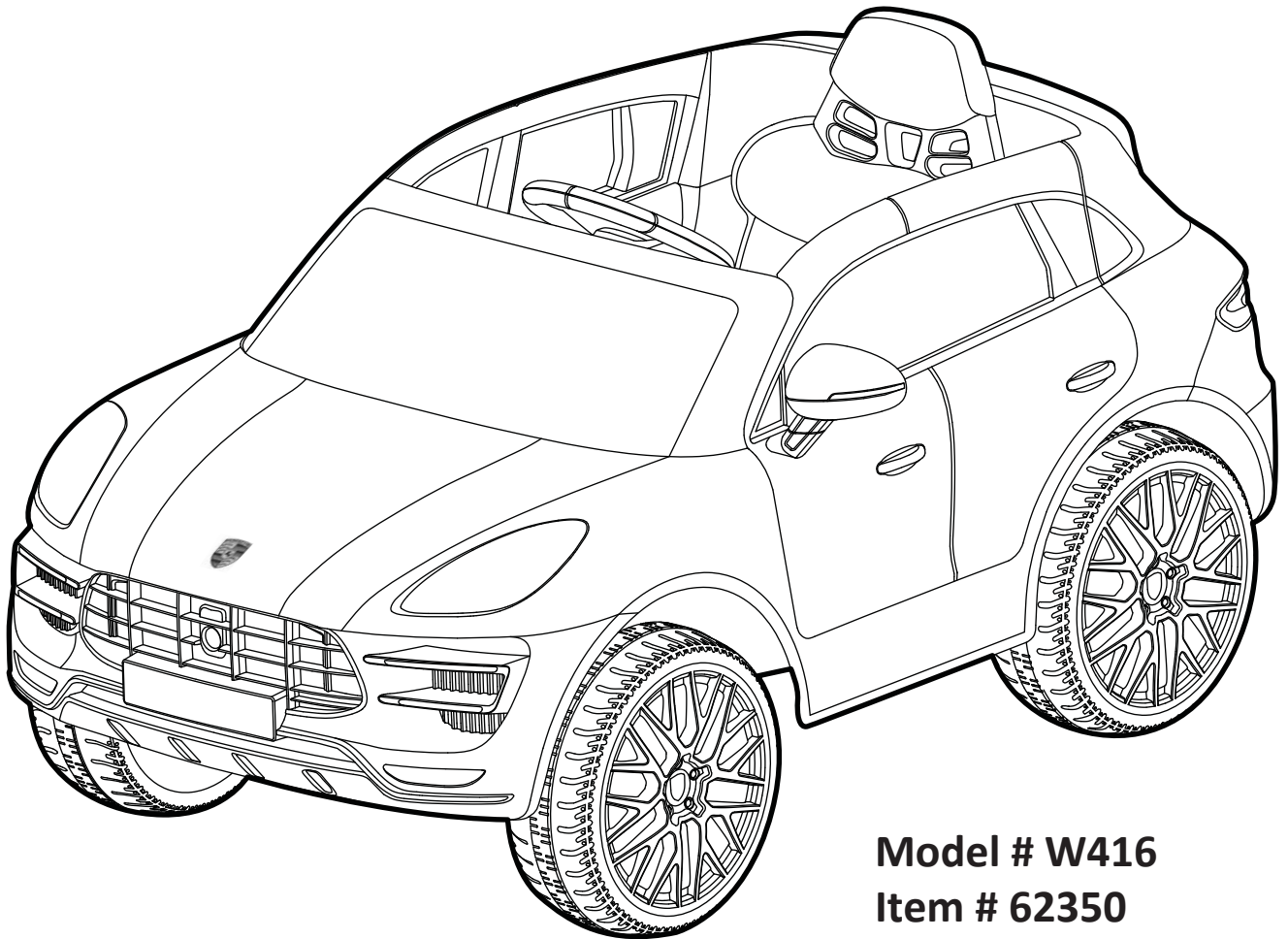

ROLLPLAY

PORSCHE MACAN TURBO



Model # W416
Item # 62350

Operator's Manual

Before using for the first time, the battery needs to be charged for a full 24 hours (no more than 30 hours)

Styles and colors may vary.
Made in China.



If you are experiencing any difficulties with this product, please contact Hunter Products Customer Service at **www.electricrideon.com.au** or **Toll Free Number 1800 224 094** for service assistance.

The owner's manual contains important safety information as well as assembly, use and maintenance instructions. The Car must be assembled by an adult who has read and understands the instructions in this manual. Keep the packaging away from children and dispose of properly before use.
Keep this manual for future reference.

Introduction

Thank you for purchasing this vehicle from Hunter Products. We hope the rider enjoys it for miles to come. Please read this instruction guide carefully before assembling and operating the vehicle. Please have your model number and serial number ready before calling. Please have proof of purchase.

Please contact Hunter Products Customer Service with any questions.

Hours: 9.00 AM - 5.00 PM (AEST), Monday - Friday

Email: enquiries@hunterproducts.com.au

Web: www.electricrideon.com.au

Toll Free Phone: 1800 224 094

Specifications:

BATTERY	6V 7AH
MOTOR	6V
AGE	3 Years and Up
MAX WEIGHT	35 kg
SPEED	4 km/h
RECHARGE TIME	8-12 Hours
TYPICAL RUN TIME	1-2 Hours
CHARGER OUTPUT	7.0V

IMPORTANT!

**YOU MUST CHARGE THE BATTERY
FOR 24 HOURS BEFORE FIRST USE!**

Charge the battery after each use.

Charge the battery at least once a month, even if the vehicle is not in use.

Email or call Customer Service if you need assistance or replacement parts.



**QUESTIONS AND SERVICE
PLEASE CALL: 1800 224 094
email: enquiries@hunterproducts.com.au**

**Read this entire manual to ensure
proper assembly and safe operation
of the vehicle.**



WARNING!

The following safety hazards may result in serious injury or death to the user of the vehicle:

- This product contains small parts that are for adult assembly only. Keep small children away when assembling. Remove and dispose of all protective material and poly bags before assembly. Be sure to remove all packaging materials and parts from underneath the car body.
- Riding the vehicle without a helmet. Riders must always wear a fitted helmet that complies with Australian Standard AS/NZS 2063:2008.
- Battery posts, terminals and related accessories contain lead and lead compounds (acid) chemicals that are toxic and corrosive. Never open the battery.
- Body parts such as hands, legs, hair and clothing can get caught in moving parts. Never place a body part near a moving part or wear loose clothing while using the vehicle. Always wear shoes when using the vehicle.
- Using the vehicle near streets, motor vehicles, drop-offs such as: steps, water (swimming pools) or other bodies of water, sloped surfaces, hills, wet areas, flammable vapors, in alleys, at night or in the dark could result in an unexpected accident.
- Always use the vehicle in a safe, secure environment with continuous adult supervision. Never leave the child unattended.
- Using the vehicle in unsafe conditions such as snow, rain, loose dirt, mud, sand or fine gravel may result in unexpected action such as tip over and skidding.
- Using the vehicle in an unsafe manner. Examples include but are not limited to:
 - Pulling the vehicle with another vehicle or similar device
 - Allowing more than one rider
 - Pushing the user from the back
 - Traveling at an unsafe speed
- Always use common sense and safe practices when using the vehicle. Different type of batteries or new and old batteries are not to be mixed.
- Not to be used in traffic.
- This toy is unsuitable for children under 3 years due to its maximum speed.
- Battery charger, electric wire plug enclosure and other parts should be periodically check for damage, if have damage, need to repair before use.
- There are additional hazards of using the toy in areas other than pirate grounds.

User Requirements

Age Range	3 and 7 years
Weight Range	35kg

Before using the vehicle the child should understand the vehicle controls and safety issues. They must also demonstrate the capability to handle the vehicle and operate its controls. It is the responsibility of the adult to educate the child and supervise the vehicles use.

Read the following safety warnings to any child using the vehicle Ride-on:



WARNING!

PREVENT INJURIES AND DEATHS:

- **NEVER LEAVE CHILD UNATTENDED. ALWAYS** keep child in view when child is in vehicle. Direct adult supervision is **REQUIRED**.
- **NEVER** use in roadways, near cars, on or near steep inclines or steps, swimming pools or other bodies of water.
- **ALWAYS** wear shoes.
- **ALWAYS** sit on the seat.
- **RISK OF FIRE.** Do not bypass.
- **NEVER** allow more than one (1) rider in the vehicle Ride on.
- Adult assembly required.
- Only use the vehicle when an adult is present to watch (supervise).
- Always sit in the seat when using the vehicle.
- Keep your hands, hair and clothes away from moving parts.
- Always wear shoes when using the vehicle.
- Only one rider is allowed at a time on the vehicle Ride-on.
- Children under three years old cannot use the vehicle.
- Only drive on level ground.
- Do not go near water, drop-offs or up and down steep slopes.
- Do not drive the vehicle into loose dirt, mud, and or fine gravel.
- Do not drive the vehicle on streets or near cars.

Charging the Battery: Warnings



WARNING!

The following safety hazards may result in serious injury or death to the user of the vehicle:



- Use of a battery or charger other than the supplied 6v rechargeable battery and charger may cause a fire or explosion. Only use the supplied 6v rechargeable battery and charger with the vehicle.
- Using the 6v rechargeable battery and charger for any other product may result in over heating, fire or explosion. Never use the 6v rechargeable battery and charger with another product.
- Explosive gases are created during charging. Charge the battery in a well ventilated area. Do not charge the battery near heat or flammable materials.
- Contact between the positive and negative terminals may result in fire or explosion. vehicle direct contact between the terminals. Picking up the battery by the wires or charger can cause damage to the battery and may result in a fire. Always pick up the battery by it's case or handles.
- Liquids on the battery may cause fire or electric shock. Always keep all liquids away from the battery and keep the battery dry.



- Contact or exposure to battery leakage (lead acid) may cause serious injury. If contact or exposure occurs immediately call your physician. If the chemical is on the skin or in the eyes, flush with cool water for 15 minutes. If the chemical was swallowed, immediately give the person water or milk. Do not give water or milk if the patient is vomiting or has a decreased level of alertness. Do not induce vomiting.

Charging the Battery: Warnings



WARNING!

- Battery posts, terminals and related accessories contain lead and lead compounds (acid), chemicals and are toxic and corrosive. Never open the battery.

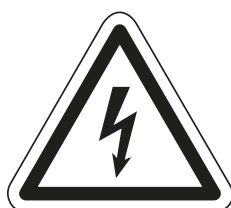

- Tampering or modifying the electric circuit system may cause a shock, fire or explosion and permanently damage to the system. Exposed wiring, circuitry in the charger may cause electric shock. Always keep the charger housing closed.

Important! Before using the vehicle for the time the battery needs to be charged for a full twenty-four hours (no more than thirty hours). Only an adult who has read and understands the following safety warnings should handle, charge or recharge of the battery (see Maintenance).

Note: It is not necessary to remove the battery from the vehicle for charging. However, if the adapter cord will not safely reach a 240V wall outlet, the battery can be removed for charging.



WARNING!

- Non-rechargeable batteries are not to be recharged;
- Batteries are to be inserted with the correct polarity;
- Exhausted batteries are to be removed from the toy;
- The supply terminals are not to be short-circuited.
- Rechargeable batteries are only to be charged under adult supervision;
- Rechargeable batteries are to be removed from the toy before being charged;

Parts List

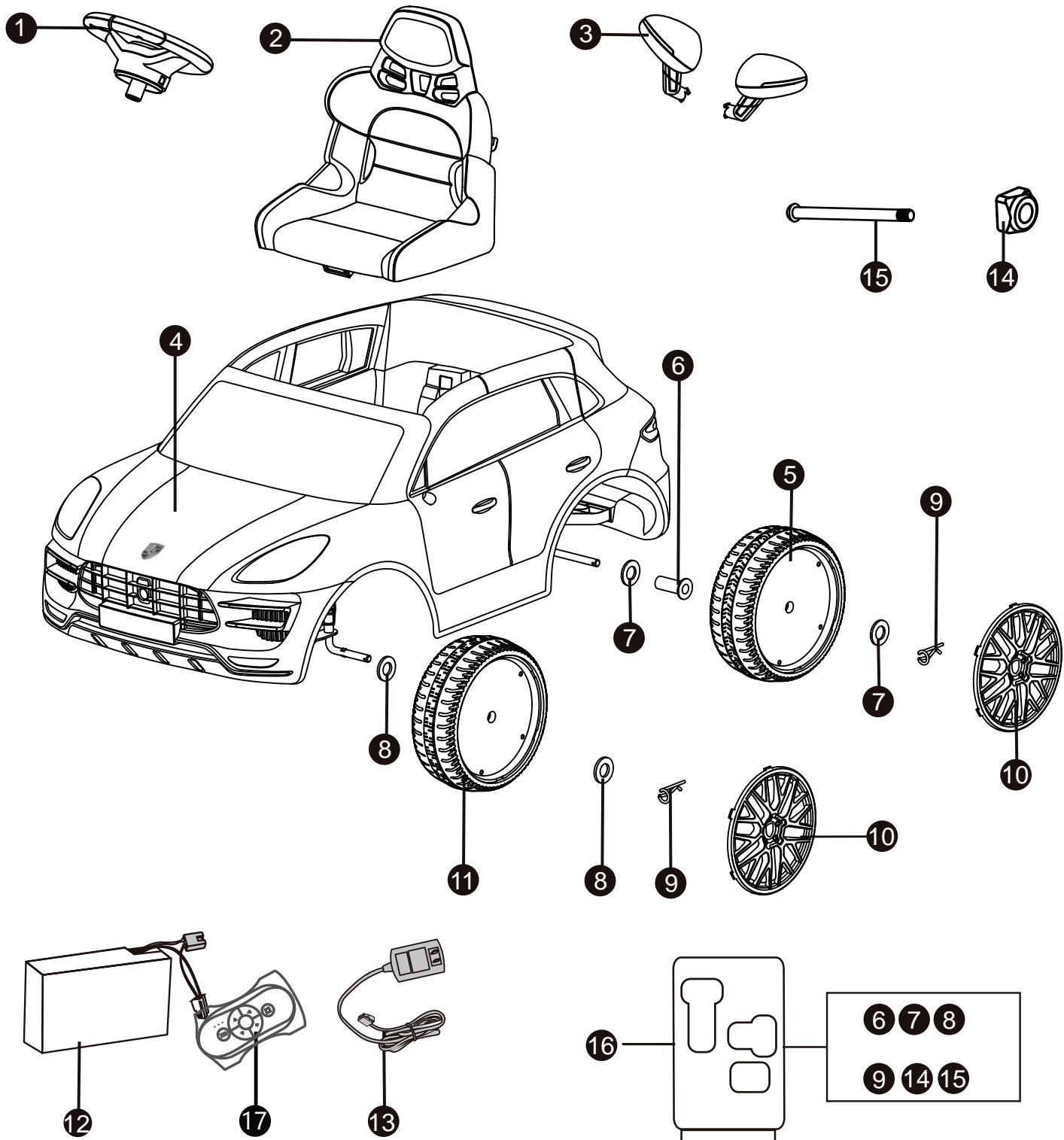

- | | | | | | |
|-------------------------|-----------------------|----------------------|--------------------------------|-----------------------|-------------------------------------|
| 1 Steering wheel | 2 Seat | 3 Wing mirror | 4 Chassis | 5 Rear wheel | 6 Rear wheel orientation rod |
| 7 Large washer | 8 Small washer | 9 Snap pin | 10 Wheel trim | 11 Front wheel | |
| 12 Battery | 13 Charger | 14 Nut | 15 Steering wheel screw | 16 Blister box | 17 Remote control |

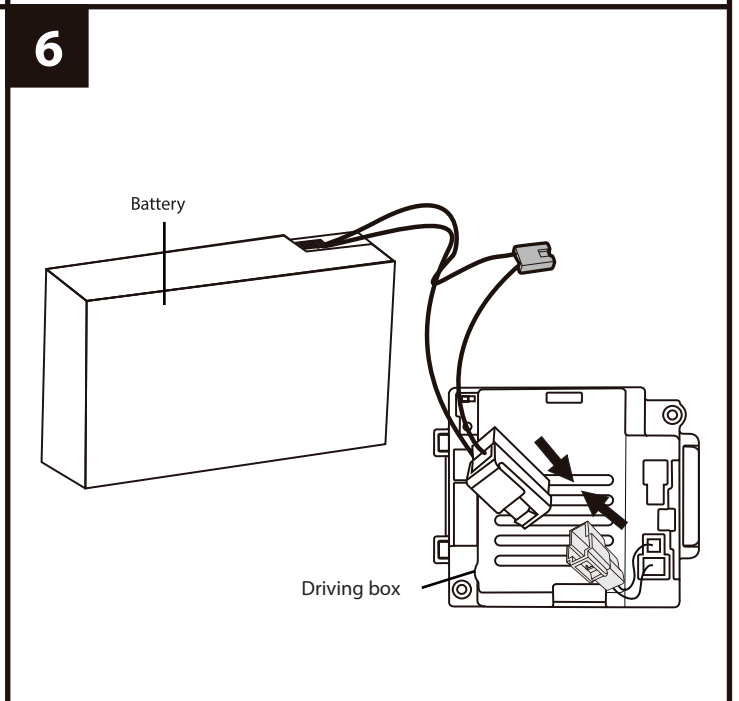
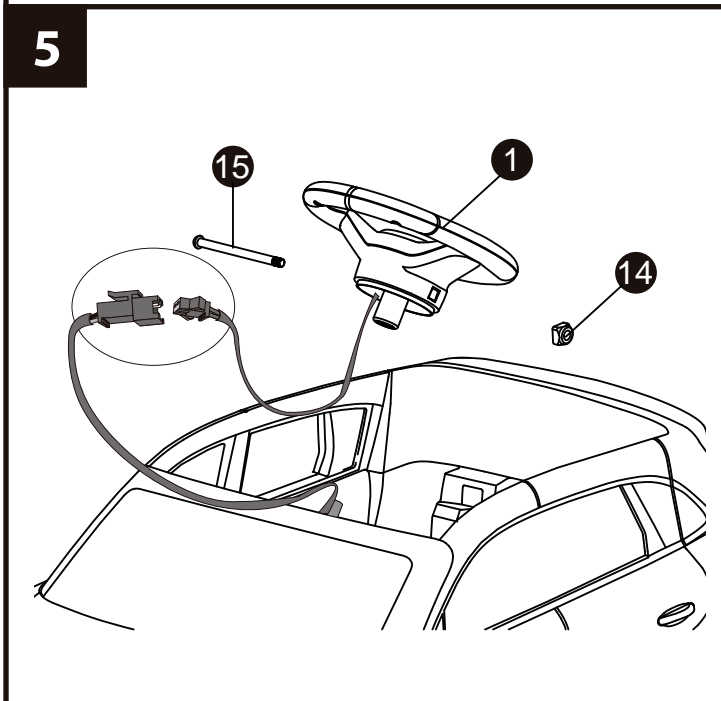
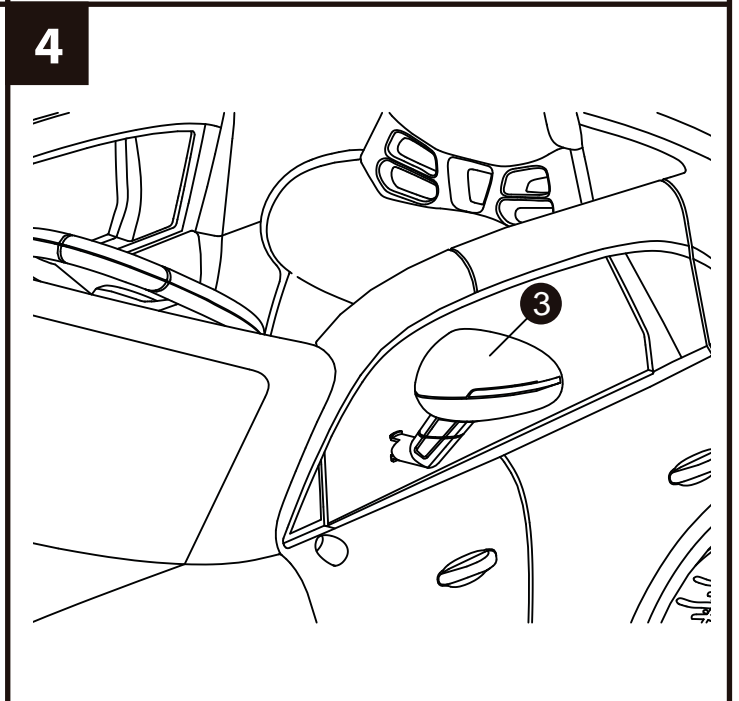
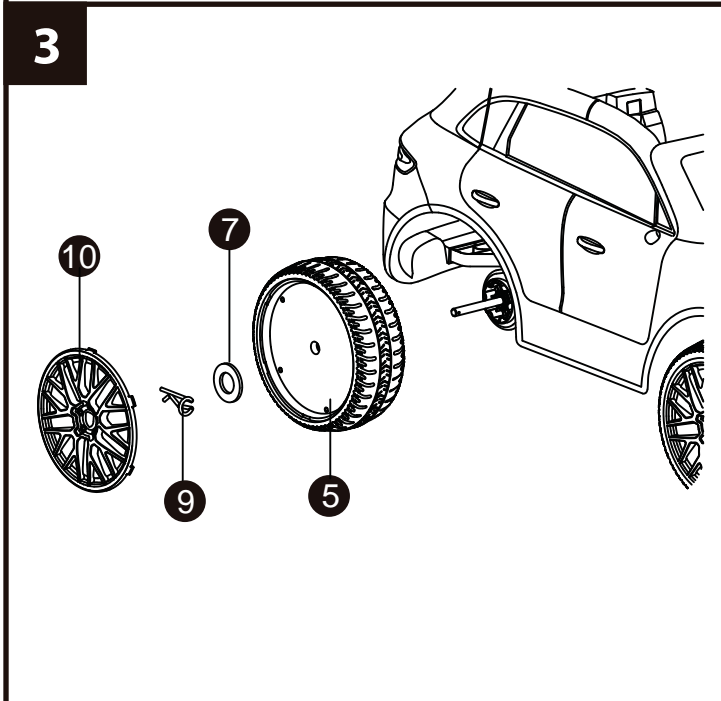
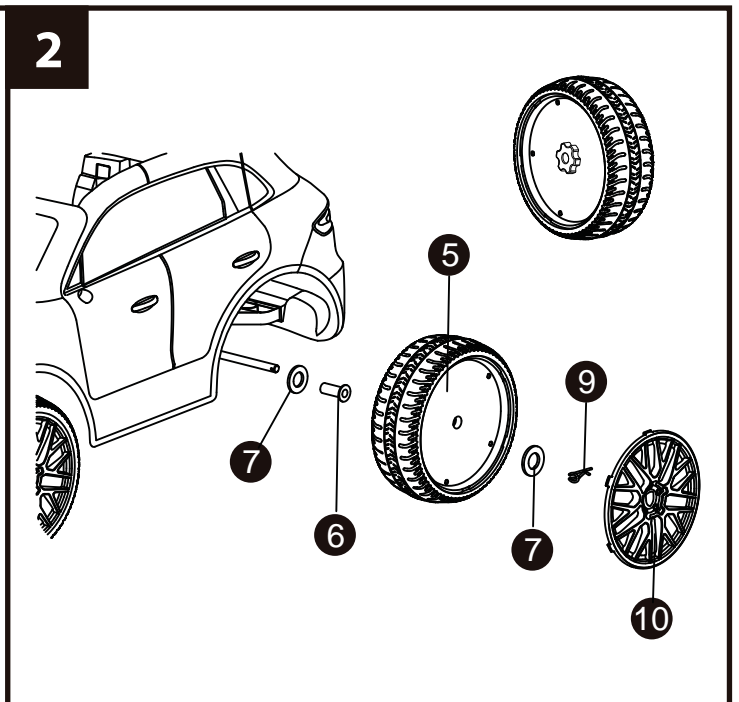
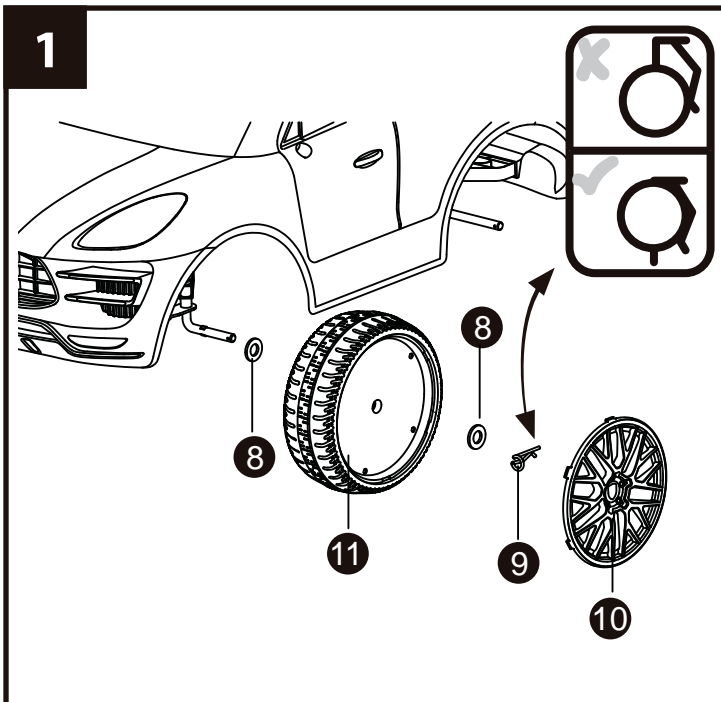

7

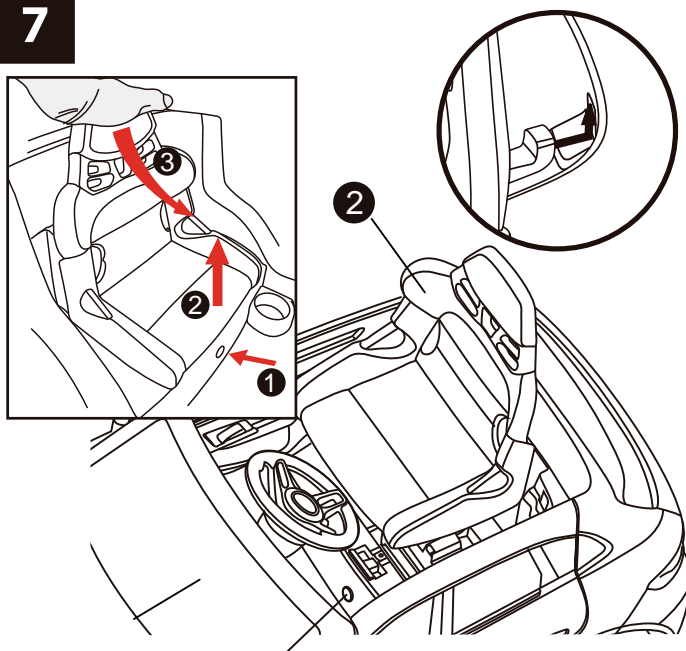

Seat release button

8

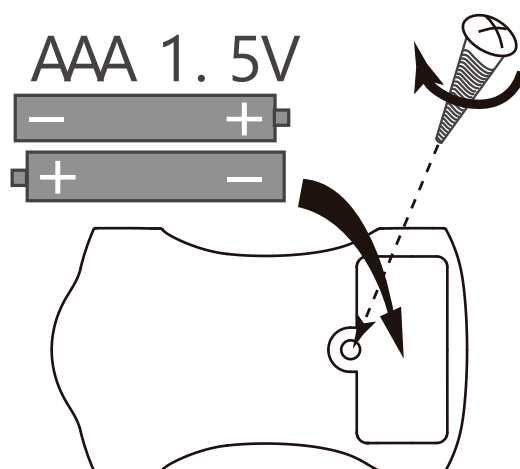

A

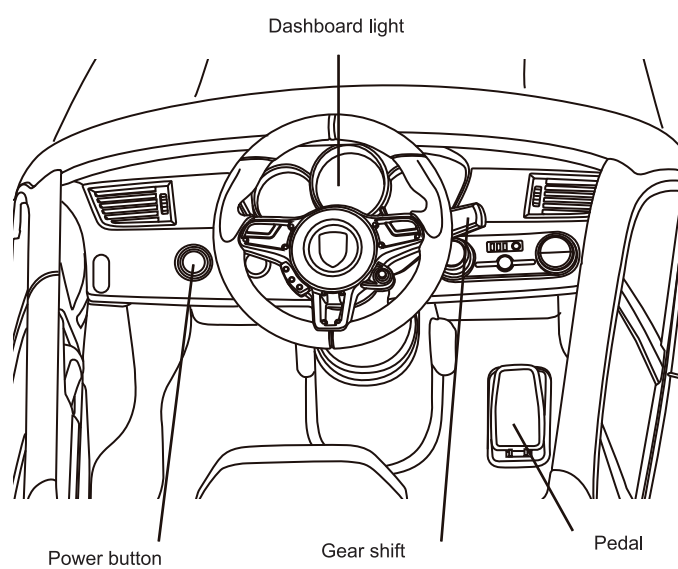

Dashboard light

Power button

Gear shift

Pedal

B

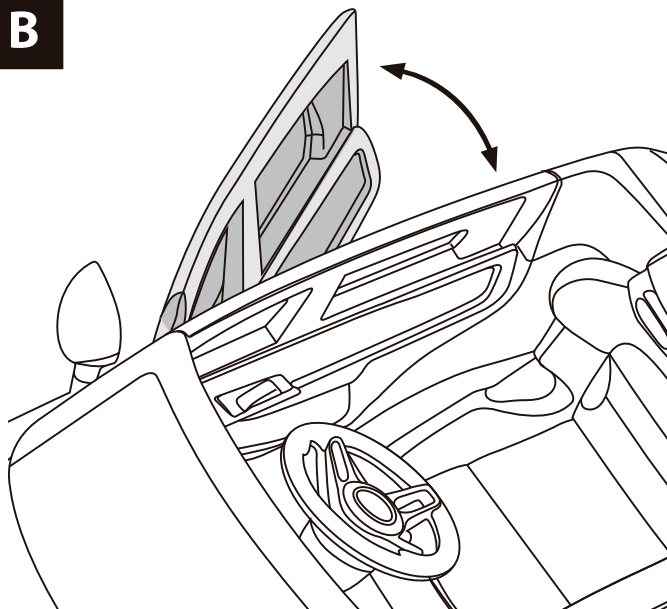

C

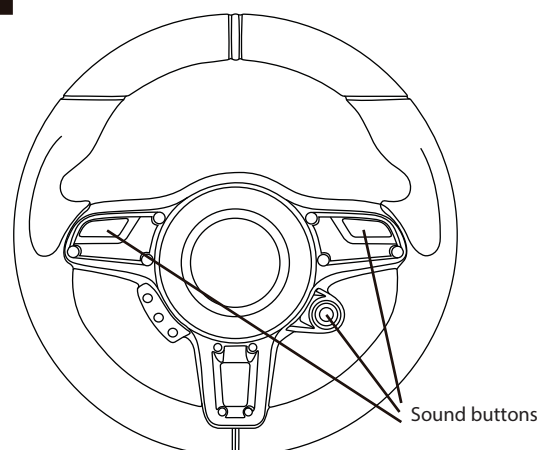

Sound buttons

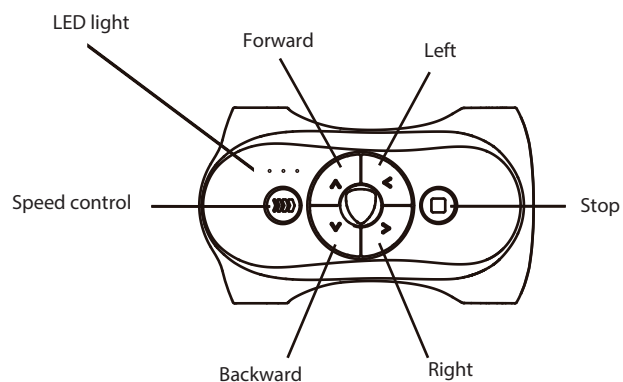
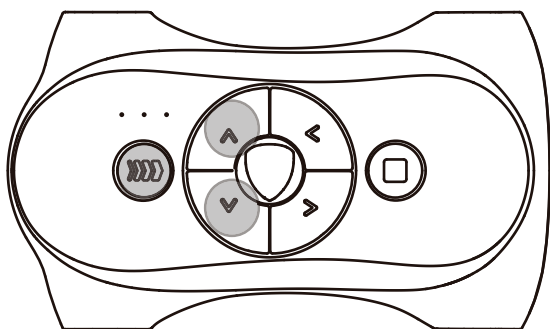
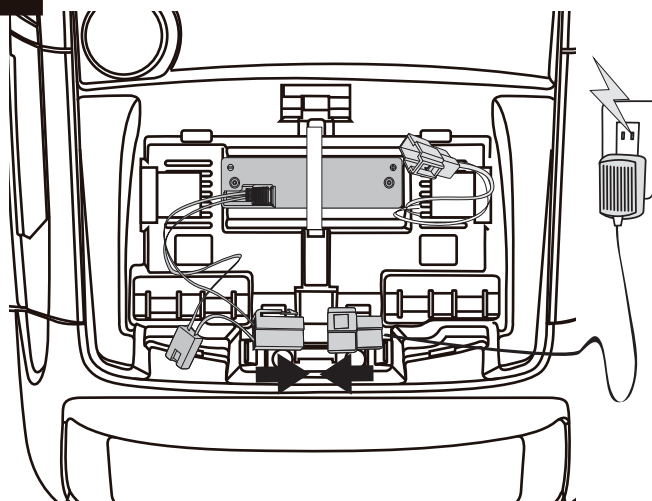
D**E****F**

WARNING!

- DO NOT mix old and new batteries.
- DO NOT mix alkaline, standard (carbon-zinc), or rechargeable (nickelcadmium) batteries.



Assembly Instructions

Manual for assembly and use:

Porsche, the Porsche shield and the distinctive design of Porsche cars are the trademarks and trade dress of Porsche AG. Permission granted.

Forward and reverse gears.

Multi-functional steering wheel with different sound effects.

With dashboard light, front light.

Thank you for purchasing this ride on vehicle, we hope that the rider enjoys it for years to come.

Please read the instruction guide carefully before using the vehicle.



Attention!



WARNING:

1. Vehicle must not be used on roads, pavements, slopes or sand.
2. Vehicle should be used on a flat surface.
3. Do not overload the vehicle. Please take note of the weight restrictions: Maximum total weight 35kg.
4. Battery charging must be performed by an adult.
5. Children riding this vehicle should be supervised at all times by a responsible adult.
6. Do not charge the circuit of the vehicle or its attaching electric equipment.
7. Do not ride in water or any other fluids.
8. Come to a stop when approaching an obstruction, turn away and use the vehicle elsewhere.
9. Please charge once the vehicle runs slowly otherwise life-span of battery will be reduced.
10. Please charge the battery in full, before storing it for long periods of time then recharge it every 3 months to prolong the battery life.
11. Do not ride in the rain.
12. Battery, charger, electric wire, plug, enclosure and other parts should be periodically check for damage, if damage is found discontinue use until repaired.
13. Charger used with the toy are to be regularly examined for damage to the cord, plug, enclosure and other parts, and that, in the event of such damage, the toy must not be used with this charger until the damage has been repaired.
14. This vehicle is unsuitable for children under 3 years old due to its maximum speed.
15. The vehicle must only use with the recommended charger.
16. The charger is not a toy.
17. Clean with a damp cloth only.
18. Check components are in good condition, if not, repair or replace them.



WARNING:

For the safety of your child please pay attention to the following:

1. Adult assembly only.
2. Small parts are of choking hazard; they are not suitable for children under 3 years!
3. Children must not open the battery protector.
4. Please keep plastic bags away from children to avoid suffocation.
5. Adult supervision required at all times.
6. This vehicle is unsuitable for children under 3 years due to its maximum speed, there are additional hazards of using the toy in areas other than private grounds.
7. The vehicle shall be used with caution since skill is required to avoid falls or collisions which may cause injury to the user and third parties.
8. Instruction must be given to the child in the proper use of the vehicle, particularly in the use of the braking system.
9. Not to be used in traffic.
10. Ride on smooth, paved surfaces away from vehicles and other road users.
11. Avoid sharp bumps, drainage grates and sudden surface changes.
12. Avoid streets and surfaces with water, sand, gravel, dirt, leaves and other debris.
13. Wet weather may impair traction, braking and visibility.
14. Do not ride at night.
15. Avoid excessive speed associated with downhill rides.
16. Watch out for pedestrians.
17. Check and secure all fasteners before each ride, do not allow 2 or more children to ride at the same time.
18. Do not use the vehicle if it has any damage.
19. Replace worn or broken parts immediately.

1. Assemble the front wheels:(Fig.1)

Insert the small washer, front wheel and small washer onto the front wheel axle in order. Lock the snap pin into the hole. Fix the wheel trim onto the wheel.

2. Assemble the left rear wheel:(Fig.2)

Insert the large washer and orientation sleeve onto the left rear wheel axle (gear box is not included on left rear wheel axle), then insert the rear wheel and a large washer into the rear left wheel axle in order (the side with the protrude should be facing the inside). Lock the snap pin into the hole and the wheel trim onto the wheel.

3. Assemble the right rear wheel:(Fig.3)

Insert the rear wheel and large washer into the rear right axle (the side with the protrude should be facing the inside). Making sure the protrude engages with gear box. Insert the snap pin into the hole and insert the wheel trim onto the wheel.

4. Assemble the wing mirrors:(Fig.4)

Insert the wing mirror into the slot of the door, pressing until you hear the click sound. Please note that the left and right mirrors are different.

5. Assemble the steering wheel:(Fig.5)

First, connect the connector on the steering wheel with the connector on the steering pole. Align the steering wheel with the steering pole and pull the wires from down to fasten. Insert the steering wheel into the steering pole. If necessary, lift the steering wheel slightly to align the hole with the hole on the pole. Please note that the side with the protrude should be towards the front. Insert a bolt into the hole and secure with the screw. Take care not to damage the wires and the buttons on the steering wheel during assembly.

6. Connect the power: (Fig. 6)

Connect the connector on the battery with the connector of the driving box.

7. Assemble the seat:(Fig.7)

Link the two pothooks on the back side of the seat into the fixing hole, place the seat on the flat position and press the front end of seat. Press the seat release button under the seat to unlock the seat, lift up the front end of the seat and pull the hook behind the seat to take out from the body fixed hole and remove the seat.

8. The Battery Use of Remote Control: (Fig. 8)

Buy 2*1.5V AAA batteries, open the battery cover by the screwdriver (not included). Put the two batteries into the battery cavity with correct polarity. Put back and fix the battery cover lastly.

Operating Instruction:

A. Forward and reverse (Fig. A)

Press the power button, and the dashboard lamps will light up. Move the gear shift to the forward position. The car will go forward and the front lights will work when the accelerator pedal is pressed. The car will stop when the pedal is released. To drive in reverse, move the gear shift to the reverse position, then press the accelerator.

The dashboard light (Fig. A)

While pressing the power button, the dashboard will light up. The lights will turn off when the power button is pressed again.

B. Opening doors (Fig. B)

Push the door outward, the door will open.

C. Steering wheel function (Fig. C)

The steering wheel features realistic sound effects.

D. Operation of Remote Control: (Fig.D)

1. Press the "Forward" button, the vehicle moves forward; press the "Backward" button, the vehicle runs backwards. Speed is up to the gear set by the remote control.
2. The "Speed" button is the speed control button, it can be set three speeds. Press the button to choose the corresponding speed. LED displays speed synchronously, full light when the speed is the fastest, a light when the speed is the slowest.
3. Press the "Left" button, the vehicle returns left; press "Right" button, the vehicle returns right.
4. Press the "Stop" button to stop the vehicle, while the LED shows a flow. Then press other buttons on the remote control, the vehicle reruns according to the button function.
5. The vehicle has soft start and soft stop function.
6. When the remote control has no operation for more than 5 seconds, it will enter into the hibernation (power-saving) mode.
7. The vehicle will be shut down automatically without operation for 2 hours.

E. Code Remote Control with E-Car: (Fig.E)

Press the forward, backward and speed control buttons at the same time. LED lights flashing showed the state into the code. Now press the power switch in 5 seconds, automatic code will be completed and LED lights are restored to normally bright state. State recovery will be closed automatically without operation for 5S. If the code fails, please repeat the above steps.

F. Battery recharge: (Fig. F)

Ensure that the vehicle is switched off before the vehicle is charged. When the battery is low please recharge. To charge please remove the seat and unplug the battery connector from the driving board connector. Connect the battery and the charger connectors, then plug the power supply into a wall socket.

Thermal fuse:

The vehicle has been fitted with a thermal fuse to protect the electrical circuit. If the vehicle cuts out during use, the fuse will automatically reset after a few moments, allowing the car to work again as normal.

Maintenance

Important Battery and Charger Information

- Only an adult who has read and understands the safety warnings may handle and operate the battery and battery charger. Keep away from children.
- Charge the battery for 24 hours before using the vehicle for the first time.
- Charge the battery immediately after each use. Charge for at least 8-12 hours, but no more than 20 hours.
- Charge the battery at least once a month, even if the vehicle is not used or stored.
- Never leave the battery in a discharged condition.
- Connect the terminal of the battery and charger, then plug the charger into a 240V AC outlet.
- It is normal for the charger to heat slightly. If the charger rises above 71°C / 160°F, disconnect the charger and call Customer Service for assistance.
- Keep the charger away from water or excessive moisture to prevent short-circuiting.
- Only use the charger specified with the original item. **Do not charge the battery with any other charger.**
- Do not attempt to recharge non-rechargeable batteries with the original charger.
- **Do not replace the battery with any other battery, or the warranty will be voided.**
Remove damaged batteries from the car immediately. Recycle or
- dispose of the used batteries responsibly.
Do not short circuit the supply terminals.
- Do not leave the battery connected in the vehicle for extended periods
- of time when the vehicle is not being used. Disconnect the battery connector from the engine connector before storing.
The vehicle is equipped with a thermal fuse to protect the electric
- circuit. If the vehicle cuts out, turn the vehicle off and on to reset.

General Care

- Regularly inspect all vehicle parts to ensure they are in good working condition.
- Regularly inspect the charger, cord, plug, and other related parts for damage.
- Remove any damaged parts and immediately contact Customer Service for replacement parts.

DO NOT operate the vehicle if there are any damaged parts.

- Carefully clean the vehicle with a damp cloth and mild soap. Do not get
- water in or near any electrical parts. Do not wash the vehicle with a hose.

Store the vehicle indoors or use a tarp to cover it. Keep away from

- stoves, heaters, or other sources of heat.

Troubleshooting Guide

Completely read through the manual and troubleshooting guide before contacting Customer Service.

Problem	Potential Cause	Solution
Vehicle does not run	Battery is low	Recharge the battery
	Thermal fuse tripped	Reset fuse
	Snap pins are loose	Tighten snap pins
	Loose wires or loose connectors	Ensure the battery connectors are securely attached. If wires are loose, contact Consumer Service for repairs
	Battery is dead	Call Customer Service for replacement battery
	Electrical system is damaged	Call Customer Service for repairs
	Motor is damaged	Call Customer Service for repairs
Vehicle only runs for a short time	Undercharged battery	Ensure a secure connection when the battery is recharging. Recharge for at least 8-12 hours
	Overcharged battery	Never charge the battery for more than 24 hours
	Battery is old	Replace battery
Vehicle runs slowly	Battery is not fully charged	Ensure a secure connection when the battery is recharging
	Battery is old	Call Customer Service to order replacement battery
	Too much weight on vehicle	Reduce weight on vehicle
	Harsh conditions	Operate the vehicle on level ground and safe surfaces

Problem	Potential Cause	Solution
Vehicle needs a push to start	Loose wires or loose connectors	Ensure the battery connectors are securely attached. If wires are loose, contact Consumer Service for repairs
	“Dead spot” on motor	A “dead spot” means electricity is not being delivered to the terminal. Contact Consumer Service for repairs
Difficulty shifting	Attempting to shift while vehicle is moving	Stop the vehicle before shifting
Motor or gear box making grinding noises	Motor or gear damage	Contact Consumer Service for repairs
Battery will not recharge	Charger is not plugged in	Plug in the charger to a functional wall outlet
	Charger is not working	Call Consumer Service for a replacement
	Loose connector or loose adapter	Check that the connectors are securely plugged in to each other
Battery makes bubbling noise while recharging	This is normal	No action required
Charger is warm	This is normal	No action required

Service and Repairs

If your product requires service, repairs or replacement parts, please visit us online at www.electricrideon.com.au

Or contact us at:

Toll Free Service Phone: 1800 224 094

email: enquiries@hunterproducts.com.au

Hours: 9.00 AM - 5.00 PM (AEST), Monday - Friday

Warranty

One-Year Limited Warranty

Hunter Products warrants that your vehicle will be free from defects in materials and workmanship for the vehicle for a period of 12 months, from the date of purchase. This warranty only applies where the product is completely and correctly assembled and used in accordance with all accompanying recommendations and users instructions. This warranty is in addition to your rights under the Australia Consumer Law.

Hunter Products, at its option will provide you with a refund or replacement parts for this product if it becomes defective within the warranty period.

Hunter Products will bear the reasonable expense of claiming the warranty. This warranty will no longer apply where the defect is a result of an accident, misuse, abuse, neglect or other causes not arising out of defects in materials or workmanship, nor does it cover damages arising out of damages arising out of service by other than an authorised service person.

Our goods come with guarantees that cannot be excluded under the Australian Consumer Law. You are entitled to a replacement or refund for a major failure and compensation for any other reasonably foreseeable loss or damage. You are also entitled to have the goods repaired or replaced if the goods fail to be of acceptable quality and the failure does not amount to a major failure.

Please retain your receipt as proof of purchase and contact Hunter Products for further assistance on how to process any warranty claims.

Business name: **Hunter Products Pty Ltd**
Business address: **Level 2, 424 Warrigal Road, Moorabbin VIC 3189, Australia**
Toll Free Phone: **1800 224 094 (Monday to Friday 9.00 to 5.00pm AEST)**
Email address: **enquiries@hunterproducts.com.au**