

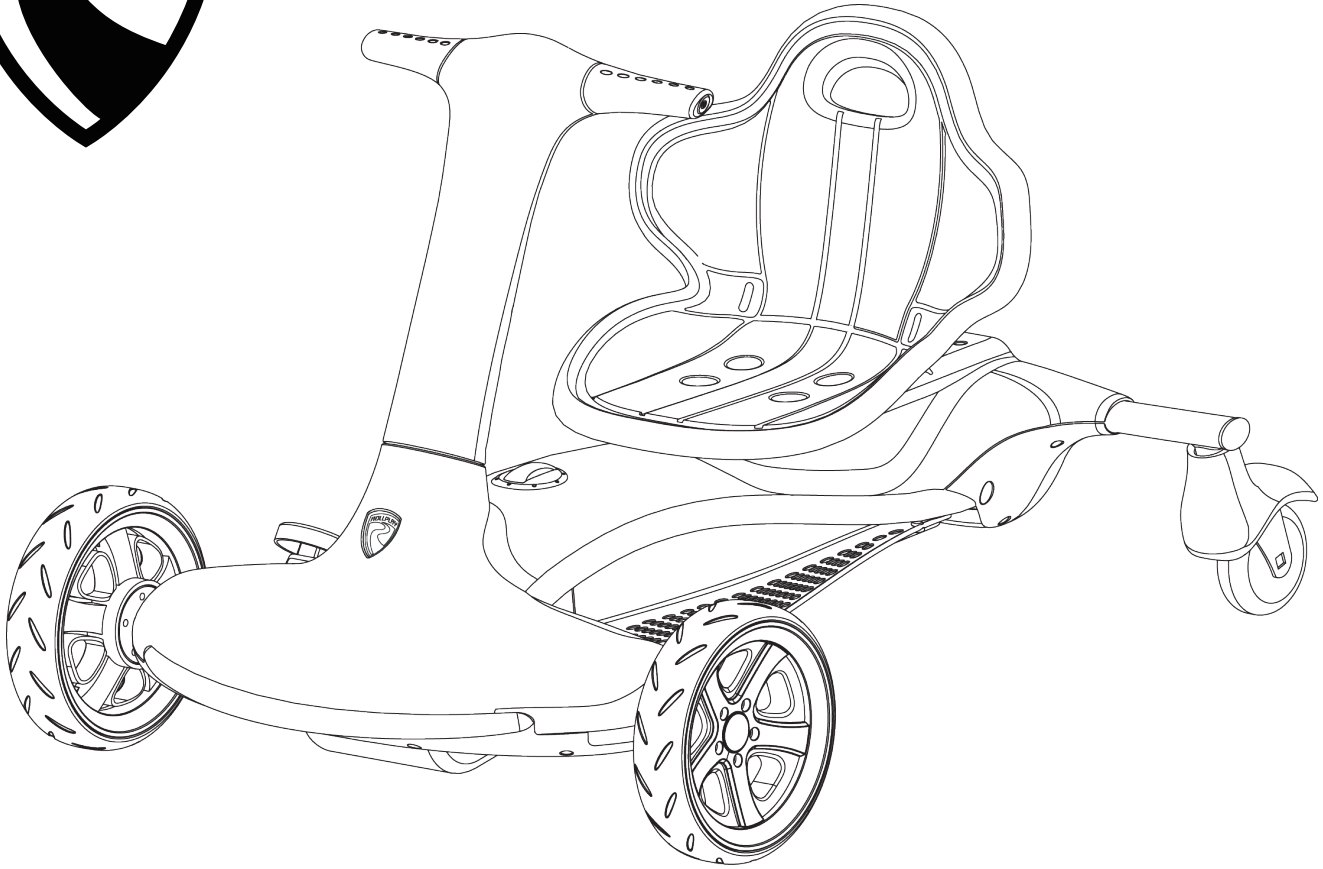

24V Turnado



Owner's Manual and Assembly Instructions

Model #: W401, W401-OB

Read and understand the entire manual before assembly and operation. The vehicle must be assembled by an adult who has read and understands the instructions.

Made in China.

Styles and colors may vary. Do not return to store. Call 1-888-982-9309 for assistance and replacement parts.

IMPORTANT:

Save this manual with your sales receipt.

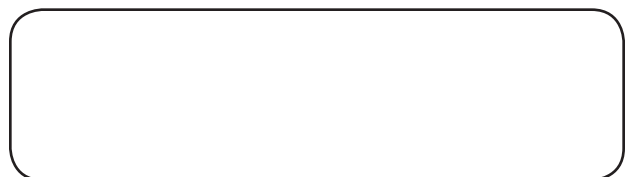

Introduction

Thank you for purchasing this Rollplay vehicle. We hope the rider enjoys it for miles to come. Please read this instruction guide carefully before assembling and operating the vehicle. Please have your model number and serial number ready before calling. Please have proof of purchase. Keep your sales receipt or register your product at www.rollplay.net.

Please contact Rollplay Customer Service with any questions.

Hours: 9 AM - 5 PM (CST), Monday - Friday

Phone: 1-888-982-9309

Email: customerservice@rollplay.net

Web: www.rollplay.net

Specifications:

BATTERY	24V 5AH
MOTOR	24V
AGE	8 Years and Up
MAX WEIGHT	68 kg (150 lbs)
PRODUCT SIZE	122 x 64.5 x 53 cm (48" x 25.4" x 20.9")
SPEED	Up To 16 km/h (Up To 12 MPH)
RECHARGE TIME	8-12 Hours
RUN TIME	30 min
CHARGER OUTPUT	DC 24V

IMPORTANT!

**YOU MUST CHARGE THE BATTERY
FOR 24 HOURS BEFORE FIRST USE!**

Charge the battery after each use.

Charge the battery at least once a month, even if the vehicle is not in use.

**DO NOT RETURN THIS ITEM
TO THE STORE!**

Call Customer Service if you need assistance or replacement parts. Please have your model number and serial number ready before calling. Please have proof of purchase. Keep your sales receipt or register your product at www.rollplay.net as we may require proof of purchase.

1-888-982-9309

**Read this entire manual to ensure
proper assembly and safe operation
of the vehicle.**

This page is intentionally left blank.

Table of Contents 5

Safety	6
Parts	8
Assemble the Handlebar	9
Assemble the Battery	10
Assemble the Seat	11
Operating Instructions	12
Charging Instructions	13
Inflate the Wheels	14
Maintenance	15
General Care	16
Troubleshooting Guide	17
Service and Repairs	18
Warranty	19
Product Registration	20



WARNING: SAFETY RIDING RULES

The user must follow all safety rules and guidelines, or serious injury or death may occur to the user.

- Always use common sense and safe practices when using the vehicle. The user must be at least 8 years old and weigh no more than 68 kg (150 lbs). The recommended rider age is only an estimate and can be affected by the rider's size, weight or skills. Any rider unable to fit comfortably on the Turnado should not attempt to ride it. A parent's decision to allow his or her child to ride this product should be based on the child's maturity, skill, and ability to follow rules.
- This product contains small parts that are for adult assembly only. Keep small children away when assembling. Remove and dispose of all protective material and plastic bags before assembly.
- Riders must always wear a fitted helmet that complies with U.S. Consumer Product Safety Commission (CPSC) Standard 16 CFR 1203. Elbow pads and kneepads, a long-sleeved shirt, long pants and gloves are recommended. Always wear athletic shoes (lace-up shoes with rubber soles), never ride barefooted or in sandals, and keep shoelaces tied and out of the way of the wheels, motor, and drive system.
- Come to a stop when approaching an obstruction, turn away and use the vehicle elsewhere.
- Only sit on the seat in the vehicle.
- Do not allow more than one rider.
- Do not overload the vehicle. Do not remove the weight restriction decals.
- Do not pull the vehicle with another vehicle or similar device.
- Keep body parts such as hands, legs, hair and clothing away from moving parts. Moving parts can cause serious injury.
- Always wear shoes in the vehicle.
- Do not operate near streets or motor vehicles.
- Do not operate near drop-offs such as steps, steep inclines or hills. Operate on relatively level ground.
- Do not operate near water, swimming pools or other fluids.
- Do not operate in dangerous weather conditions such as rain or snow.
- Do not operate near loose dirt, mud, sand or fine gravel.
- Do not operate near flammable vapors (gasoline, paint thinner, acetone, etc.).
- Always use the vehicle in a safe, secure environment with adult supervision.
- The vehicle should be used with caution as skill is required to avoid falls or collisions causing injury to the user and third parties.
- Do not touch the electric motor on your product when in use as it can become very hot.
- Do not activate the foot pedal throttle unless you are seated and in a safe, outdoor environment suitable for riding, with the seat belt fastened.
- This product was manufactured for performance and durability, but is not impervious to damage. Bumping into obstacles, jumping or other aggressive riding can overstress and damage any product, including the Turnado, and the rider assumes all risks associated with high-stress activity.
- 3Maintain a hold on the handle at all times.

PREVENT INJURIES AND DEATHS:

NEVER LEAVE CHILD UNATTENDED. ALWAYS keep child in view when child is in vehicle. Direct adult supervision is **REQUIRED**.

NEVER use in roadways, near cars, on or near steep inclines or steps, swimming pools or other bodies of water.

ALWAYS wear shoes

ALWAYS sit on the seat

RISK OF FIRE. Do not bypass.



WARNING: BATTERY SAFETY

- Battery posts, terminals and related accessories contain lead and lead compound (acid) chemicals known to the state of California to cause cancer, reproductive harm, and are toxic and corrosive. DO NOT open the battery.



- Contact exposure to battery leakage (lead acid) may cause serious injury. Immediately contact your doctor if exposure occurs. If the chemical is on the skin, flush immediately with cool water for 15 minutes. If the chemical is swallowed, immediately give the person water or milk. Do not give water or milk if the person is vomiting or has decreased alertness. Do not induce vomiting.

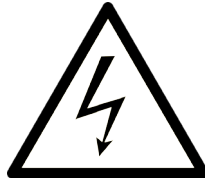

- Tampering with or modifying the electric circuit system may cause shock, fire or explosion. It could permanently damage the system. Keep the charger housing closed to prevent exposed wiring, which may cause electric shock.

IMPORTANT: Before using the vehicle for the first time, the battery must be charged for a full 24 hours (no more than 30 hours).



WARNING: ADULT SUPERVISION REQUIRED

- Before using the vehicle, the rider must understand the vehicle controls and safety issues.
- It is the responsibility of the adult to educate the child and to determine if the child is capable of understanding the vehicle controls.
- An adult must ALWAYS directly supervise the use of this vehicle.
- NEVER leave a child unsupervised in the vehicle.

8 Parts

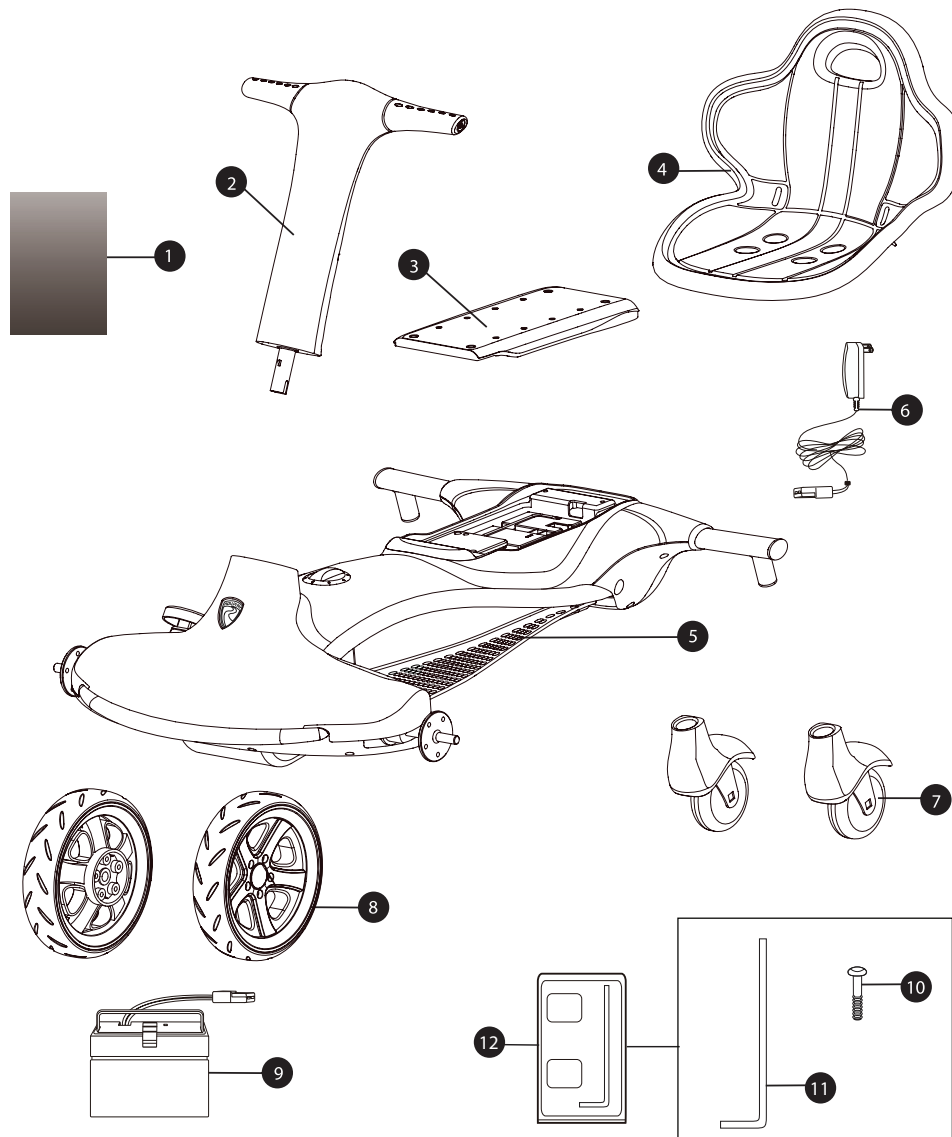

- | | |
|------------------|------------------------|
| 1. Manual | 10. Self-Tapping Screw |
| 2. Handlebar | 11. Wrench |
| 3. Battery Strip | 12. Blister Pack |
| 4. Seat | |
| 5. Body | |
| 6. Charger | |
| 7. Rear Wheel | |
| 8. Front Wheel | |
| 9. 24V Battery | |

Not Included:



- Phillips screwdriver

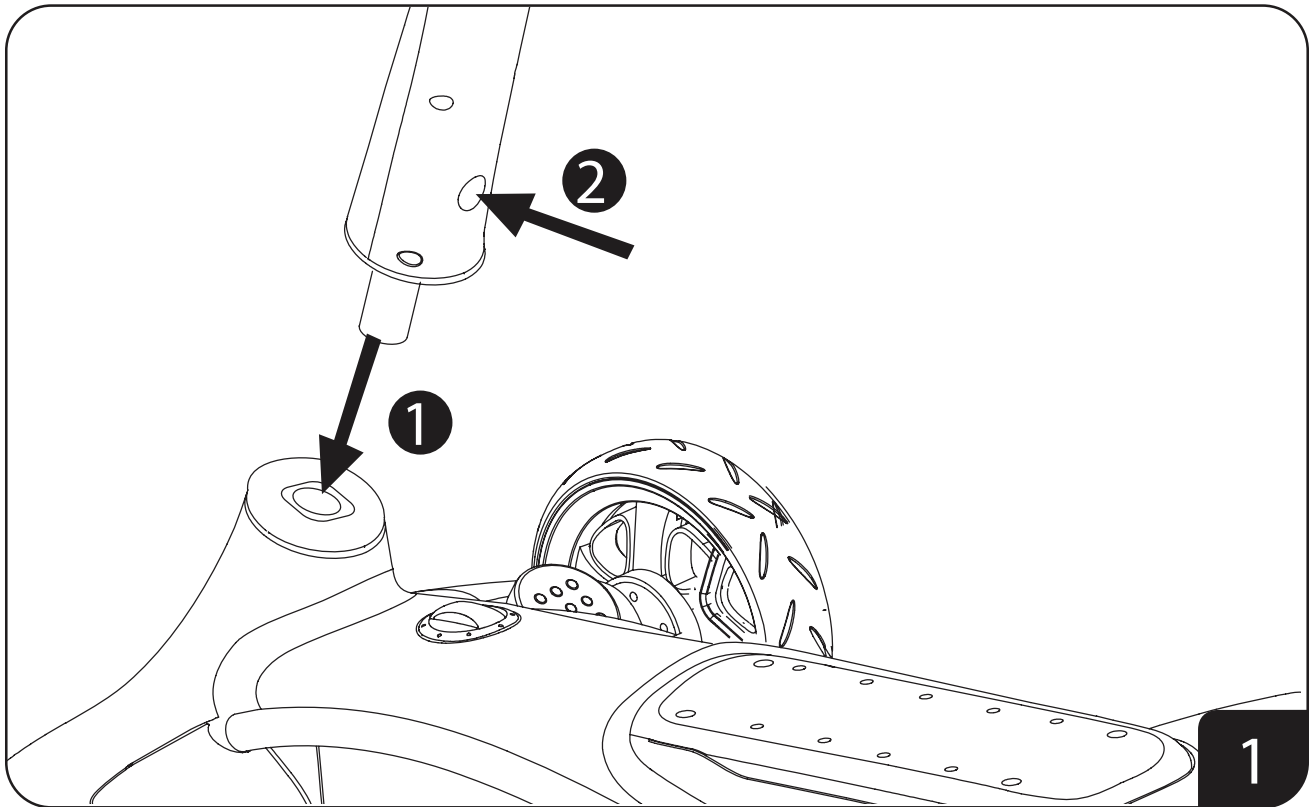

1. Insert the steel end of the handlebar into the hole on the front of the vehicle until it clicks into place.
2. To remove the handlebar, push the button (2) on the bottom of the handlebar. Then pull the handlebar out from the vehicle.

10 Assemble the Battery

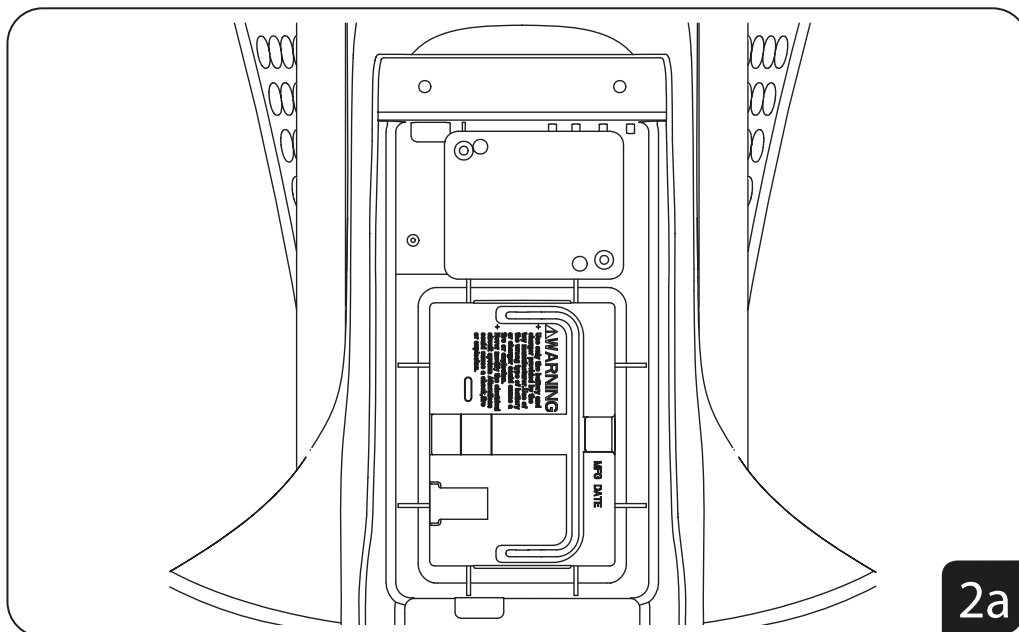
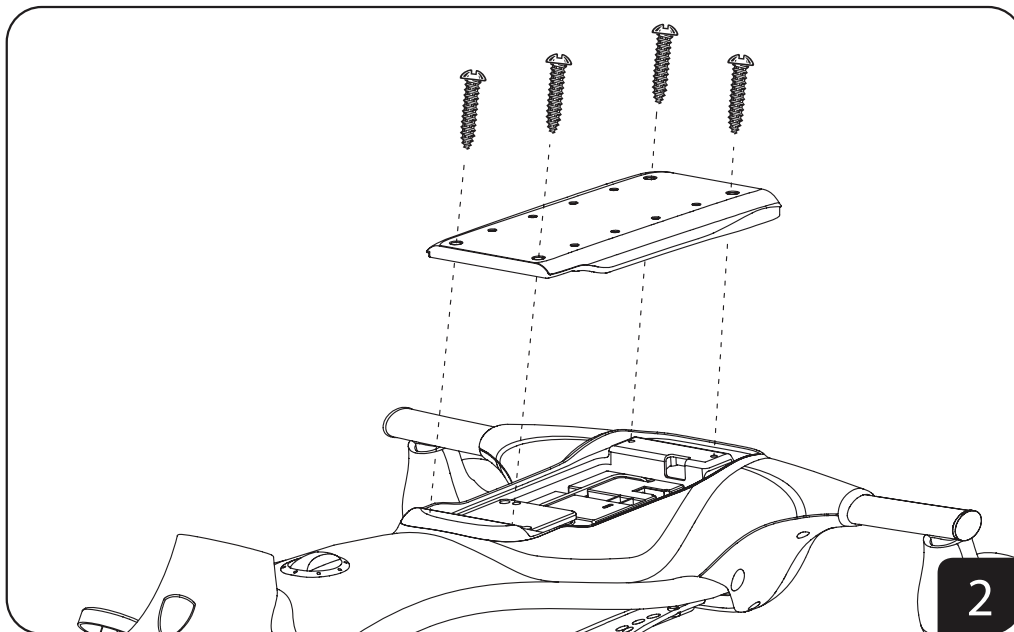

1. To connect the battery to the vehicle, use a Phillips screwdriver to remove the four screws on the seat plate.
2. Remove the seat plate.
3. Attached the white battery connector to the white engine connector.
4. Place the seat plate back on the vehicle, then use the a screwdriver to secure the seat plate with the four screws.

IMPORTANT: Only use the 24V charger and battery included with this vehicle.

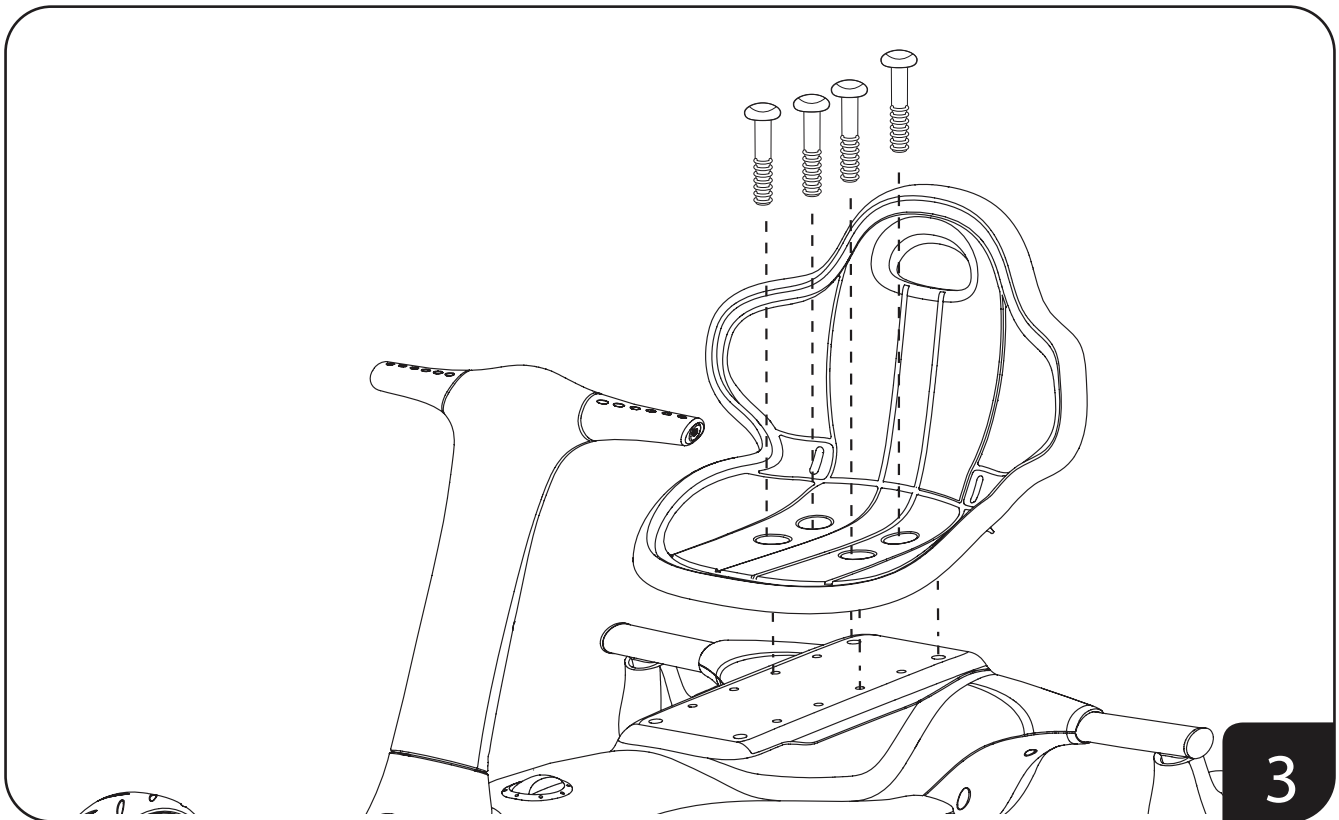

1. The seat can be adjusted to three positions on the vehicle. Align the four holes on the seat over the holes on the seat plate to the desired position.
2. Insert the screws into the holes on the seat.
3. Use the turn key to tighten the screws.

12 Operating Instructions

- Before riding the product ensure the rider is seated with the seatbelt fastened. The rider should always wear a helmet and other protective gear such as elbow pads and knee pads.

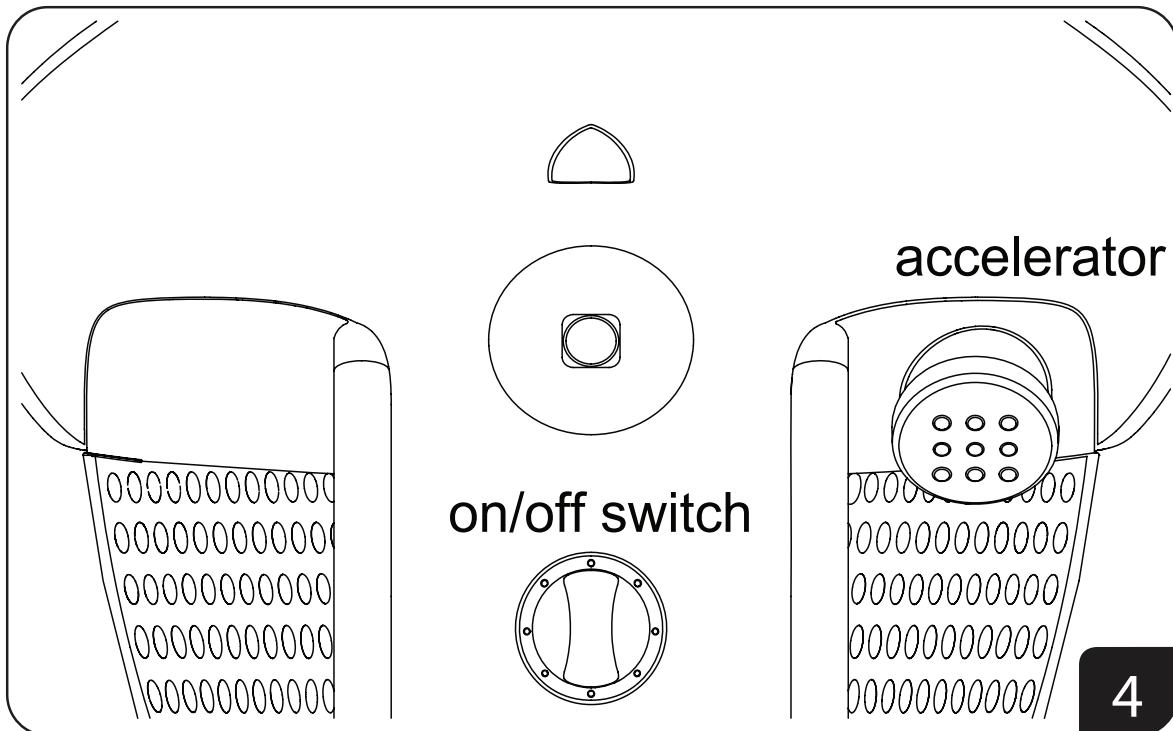

- **ON/OFF:** Turn the On/Off Switch counter clockwise in the direction of the arrow.
- **To Drive:** Grip the handlebar tightly, and press down on the foot pedal to go forward.
- **To Drift:** Accelerate on the vehicle, then turn the handlebars in the desired direction. The back wheels will create a drifting motion as shown in image 4a.
- **To Spin:** Turn the handlebars in the desired direction.
- **To Stop:** Release the foot pedal.

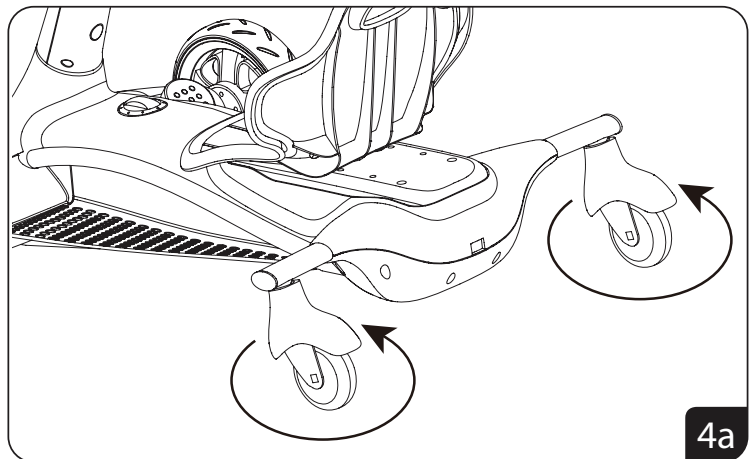

Charging Instructions

YOU MUST CHARGE THE BATTERY FOR 24 HOURS BEFORE THE FIRST USE!

ONLY AN ADULT SHOULD HANDLE THE BATTERY AND CHARGER.

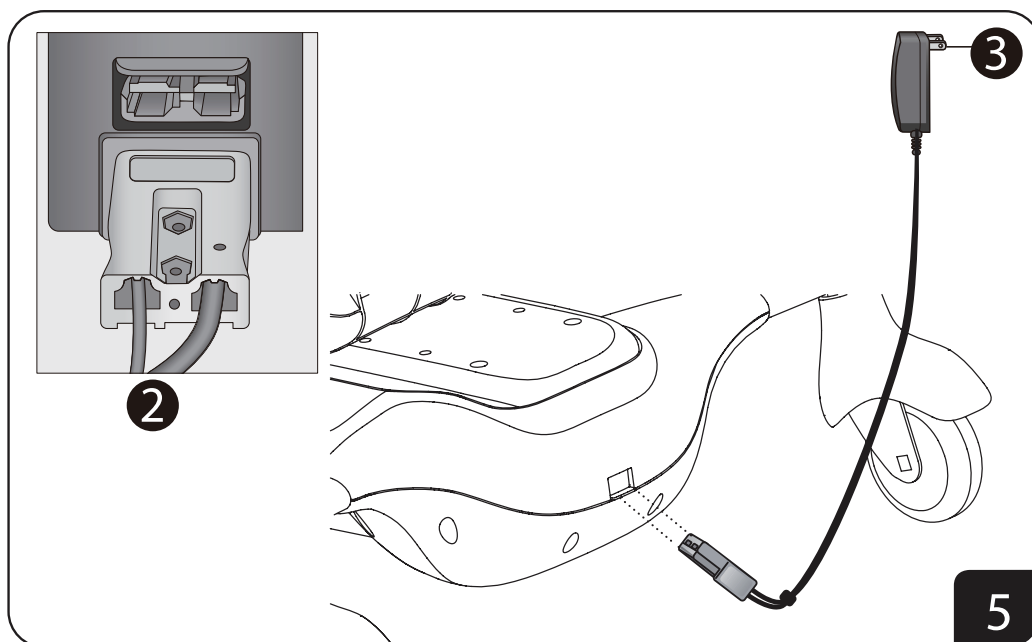

To Charge the Battery:

1. Ensure the vehicle is stopped and turned off.
2. Ensure the battery has been installed inside the vehicle body (see Page 11).
3. Lift the charging cap located on the rear of the vehicle body.
4. Insert the charger connector into the charging port.
5. Plug the charger into a standard 120V wall outlet.
6. After charging is complete, unplug the charger from the wall outlet. Then unplug the charger connector from the charging port.

Note: The charger may feel warm during charging. This is normal and not a cause for concern.

14 Inflate the Wheels

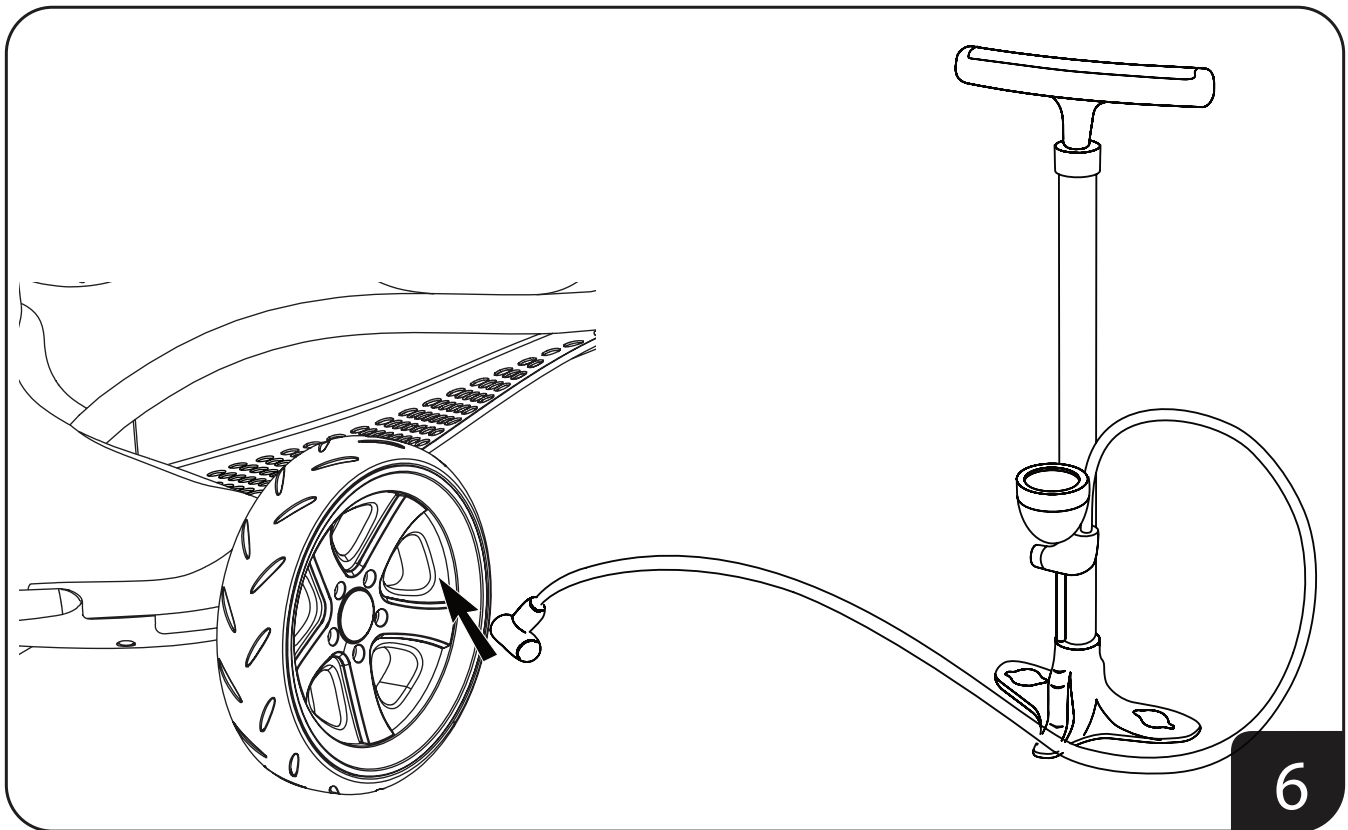

1. The front tires are inflated when shipped, but they will have lost some pressure between shipping and the point of purchase.
2. Always inflate the tires to the correct PSI before using.
3. Use a standard bicycle tire pump. Remove the valve on the front wheels, attach the pump to the valve, then inflate the tire until it reaches the PSI as indicated on the sidewall of the tire. **DO NOT OVER-INFLATE THE TIRES.**

Important Battery and Charger Information

- Only an adult who has read and understands the safety warnings may handle and operate the battery and battery charger. Keep away from children.
- Charge the battery for 24 hours before using the vehicle for the first time.
- Recharge the battery immediately after each use. Charge for at least 8-12 hours, but no more than 20 hours.
- Charge the battery at least once a month, even if the vehicle is not used or stored.
- Never leave the battery in a discharged condition.
- Connect the terminal of the battery and charger, then plug the charger into a 120V AC outlet.
- It is normal for the charger to heat slightly. If the charger rises above 71°C / 160°F, disconnect the charger and call Customer Service for assistance.
- Keep the charger away from water or excessive moisture to prevent short-circuiting.
- Only use the charger specified with the original item. **Do not charge the battery with any other charger.**
- Do not attempt to recharge non-rechargeable batteries with the original charger.
- **Do not replace the battery with any other battery, or the warranty will be voided.** If you need a replacement battery, see Page 19 for replacement information.
- Remove damaged batteries from the car immediately. Recycle or dispose of the used batteries responsibly.
- Do not short circuit the supply terminals.
- Do not leave the battery connected in the vehicle for extended periods of time when the vehicle is not being used. Disconnect the battery connector from the engine connector before storing.
- The vehicle is equipped with a thermal fuse to protect the electric circuit. If the vehicle cuts out, turn the vehicle off and on to reset.

16 General Care

- Regularly inspect all vehicle parts to ensure they are in good working condition.
- Regularly inspect the charger, cord, plug, and other related parts for damage.
- Remove any damaged parts and immediately contact Customer Service for replacement parts. See Service information on Page 19.
- DO NOT operate the vehicle if there are any damaged parts.
- Carefully clean the vehicle with a damp cloth and mild soap. Do not get water in or near any electrical parts. Do not wash the vehicle with a hose.
- Store the vehicle indoors or use a tarp to cover it. Keep away from stoves, heaters, or other sources of heat.

Completely read through the manual and troubleshooting guide before contacting Customer Service.

Problem	Potential Cause	Solution
Vehicle does not run	Battery is low	Recharge the battery
	Battery terminal connector loose or detached	Reconnect battery connector
	Battery not charged	Recharge Battery
	Electrical Components Broken	Call Customer Service for troubleshooting
	Battery is dead	Call Customer Service for replacement battery
	Drive chain fell off	Reinstall the chain
	Motor is damaged	Call Customer Service for repairs
Vehicle only runs for a short time	Undercharged battery	Ensure a secure connection when the battery is recharging. Recharge for at least 8-12 hours
	Overcharged battery	Never charge the battery for more than 30 hours
	Battery is old	Replace battery
Vehicle runs slowly	Battery is not fully charged	Ensure a secure connection when the battery is recharging
	Battery is old	Call Customer Service to order replacement battery
	Too much weight on vehicle	Reduce weight on vehicle 68 kg / 150lbs
	Harsh conditions	Operate the vehicle on level ground and safe surfaces
	Flat Tire	Inflate the tire
	Caster Wheel is Worn	Call Customer Service
Motor or gearbox making grinding noise	Motor or gear damage	Call Customer Service
Vehicle unable to drift	Caster wheel screw is loose	Tighten the screw
	Caster wheel is worn	Replace caster wheel
	Flat Tire	Inflate the Tire

Do not return this vehicle to the store.

If your product requires service, repairs or replacement parts, please contact RollPlay Customer Service.

Hours: 9 AM - 5 PM (CST), Monday - Friday

Phone: 1-888-982-9309

Email: customerservice@rollplay.net

Web: www.rollplay.net

For a list of available replacement parts, please visit www.rollplay.net.

WE WILL REQUIRE PROOF OF PURCHASE. Please save your sales receipt or register your product at www.rollplay.net.

RollPlay 24-Volt Limited Warranty

- One-year limited warranty from the date of purchase with proof of purchase from an RollPlay certified retailer.
- Six month limited warranty on the 24-Volt battery with proof of purchase from an RollPlay certified retailer.
- This one-year limited warranty covers the ride-on vehicle against defects in materials and workmanship to the original purchaser. **Proof of purchase receipt from an RollPlay certified reseller is required.**
-
- RollPlay ensures the original 24-Volt battery is warranted for 6 months from initial purchase of the vehicle from a certified retailer. Proof of purchase receipt required.
- This warranty covers normal use and does not cover the RollPlay vehicle or battery if deemed damaged by unreasonable use, modification, neglect, accident, abuse, misuse, improper service or other causes not arising out of defects in materials or workmanship. Evidence of any attempt at consumer repair will void this warranty.
- This warranty does not cover, and is not intended to exclude any liability on the part of RollPlay, whether under this warranty or implied by law for any indirect or consequential damages for breach of warranty. Some states may not allow the exclusion or limitation so this limitation may not apply to you.

Should you need service or assistance with your vehicle during the warranty period:

- Please do not return vehicle to the store.
 - Consult the troubleshooting guide in this manual and online at www.rollplay.net
- or
- Call RollPlay Customer Service at 1-888-982-9309

Note: This warranty gives you specific legal rights. You may also have other rights that may vary from state to state.

Please save your original sales receipt.

20 Product Registration

Fill out the form below and mail it to:

RollPlay Products
1131 W Blackhawk St.
Second Floor
Chicago, IL 60642

OR fill out the form online at **www.rollplay.net**

We will use the information provided only for your warranty. We will not sell, rent or share your personal information.

Product Registration

First Name: _____ Last Name: _____ Title: _____

Address: _____

City: _____ State: _____ Zip Code: _____

Email: _____ Phone: _____

Date of Purchase: _____

The following product information is on the cover of the owner's manual.

Product Name: _____ Model Number: _____

Serial Number: _____ Retailer Place of Purchase: _____

Questions or comments? Contact us at www.rollplay.net or 1-888-982-9309